A photograph of a modern building's exterior. The focus is on a balcony with a glass railing system. The railing consists of glass panels held in place by metal clamps. The building has a light-colored facade and large windows. A dark metal frame with glass panels is visible on the roof. A downspout is visible on the right side of the building.

ONLEVEL

GLASS CLAMPS
**GLASS CLAMP SYSTEMS
WITH ABP CERTIFICATE**

GLASS CLAMPS

Glass clamp systems with AbP certificate

Glass clamps

Don't get clamped – ensure everything stays where it belongs.

Essential Features

- | Stainless steel clamps in V2A and V4A
- | Suitable for glass of 8-12.76 mm thick
- | Security pin and plate available
- | Mounting flat and 42.4 mm radius
- | Models 5300 and 5310 can be combined

Model 5100

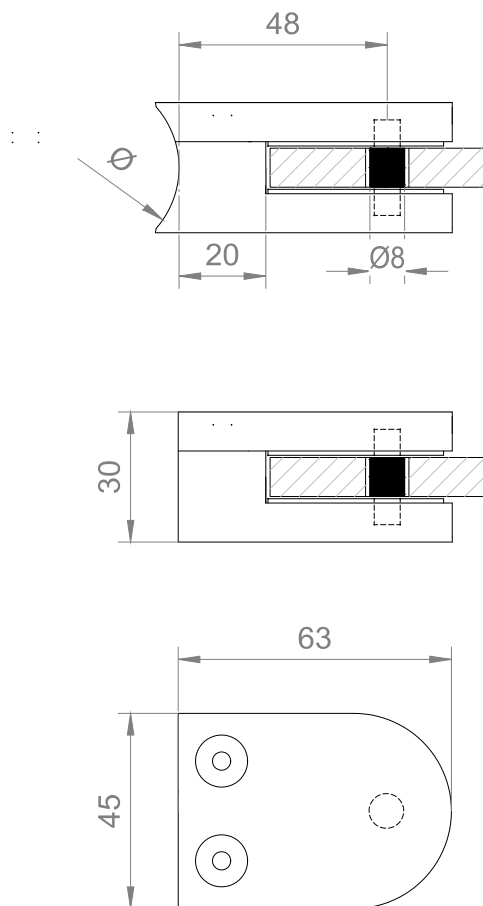

Model 5300*/5310

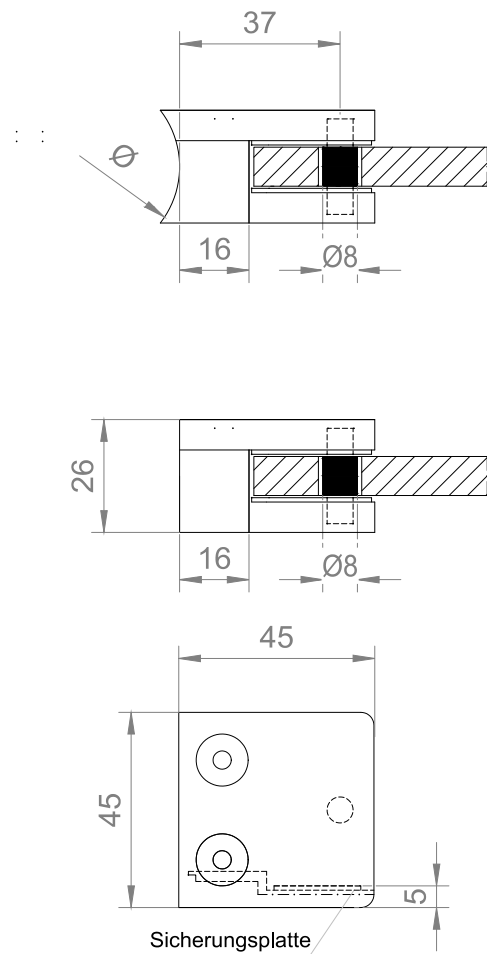

Model 5310
Model 5300



GLASS CLAMP SYSTEMS WITH ABP CERTIFICATE

Glass clamp



- | For 8-12.76 mm thick glass, incl. security pin
- | Mounting: flat
- | VE: 4 pcs

Modell 5100	
Material	Art. no.
AISI 304	12.5100.000.21
AISI 316	12.5100.000.31

Glass clamp



- | For 8-12.76 mm thick glass, incl. security pin
- | Mounting: 42.4 mm radius
- | VE: 4 pcs

Modell 5100	
Material	Art. no.
AISI 304	12.5100.420.21
AISI 316	12.5100.420.31

Glass clamp



- | For 8-10.76 mm thick glass, incl. security pin and security plate
- | Mounting: flat
- | VE: 4 pcs

Modell 5310	
Material	Art. no.
AISI 304	12.5310.000.21
AISI 316	12.5310.000.31

Glass clamp



- | For 8-10.76 mm thick glass, incl. security pin and security plate
- | Mounting: 42.4 mm radius
- | VE: 4 pcs

Modell 5310	
Material	Art. no.
AISI 304	12.5310.420.21
AISI 316	12.5310.420.31

GLASS CLAMP SYSTEMS WITH ABP CERTIFICATE

Glass clamp



| For 8 - 10.76 mm thick glass
| Mounting: flat
| VE: 4 pcs

Modell 5300	
Material	Art. no.
AISI 304	12.5300.000.21
AISI 316	12.5300.000.31

Glass clamp



| For 8 - 10.76 mm thick glass
| Mounting: 42.4 mm radius
| VE: 4 pcs

Modell 5300	
Material	Art. no.
AISI 304	12.5300.420.21
AISI 316	12.5300.420.31

Glass clamp rubber inlay



| For model 5100
| VE: 8 pcs

Modell 5100	
For glass thickness	Art. no.
8.76 mm	90.5100.008.76
10.76 mm	90.5100.010.76
12.76 mm	90.5100.012.76

Glass clamp rubber inlay



| For models 5300 and 5310
| VE: 8 pcs

Modell 5300 & 5310	
For glass thickness	Art. no.
8.76 mm	90.5300.008.76
10.76 mm	90.5300.010.76





A photograph of a modern, light-colored building with a balcony. The balcony is enclosed with a glass railing system, featuring dark metal frames and large glass panels. The building has large windows and a flat roof with a dark metal structure. The sky is overcast.

ONLEVEL

ONLEVEL GmbH | Budberger Straße 5 | 46446 Emmerich am Rhein | Germany
+49 (0)2822 97514-0 | info@onlevel.com | www.onlevel.com