

ONLEVEL



TL3120 - TL3121
SYSTEMS FOR FRAMELESS
ALL-GLASS BALUSTRADES

TL-3120

0.74 kN Top Mount

At Eye Level.

Do you live in a kind of nuclear bunker and your ceiling structure is really high? Then **TL-3120** is just right for you. Your problem solver for higher ceiling structures, with a profile height of 180 mm. Screed, insulation and concrete – and all of them very high – are no problem as **TL-3120** conceals the entire construction and is exactly at eye level.

TL-3120 can withstand a linear load of 1.0 kN and is suitable for glass thicknesses between 12 mm and 21.52 mm.

Essential Features

- | Slimline, elegant design and low-maintenance
- | **ONLEVEL FLEXFIT** Glass Adjustment Tool
- | Cover (optional)
- | Extension pin channels
- | For use with Top Cover 2.0 kN
- | Integrated multifunctional sophisticated chamber
- | For higher floor structures
- | For glass thicknesses between 12 - 21.52 mm

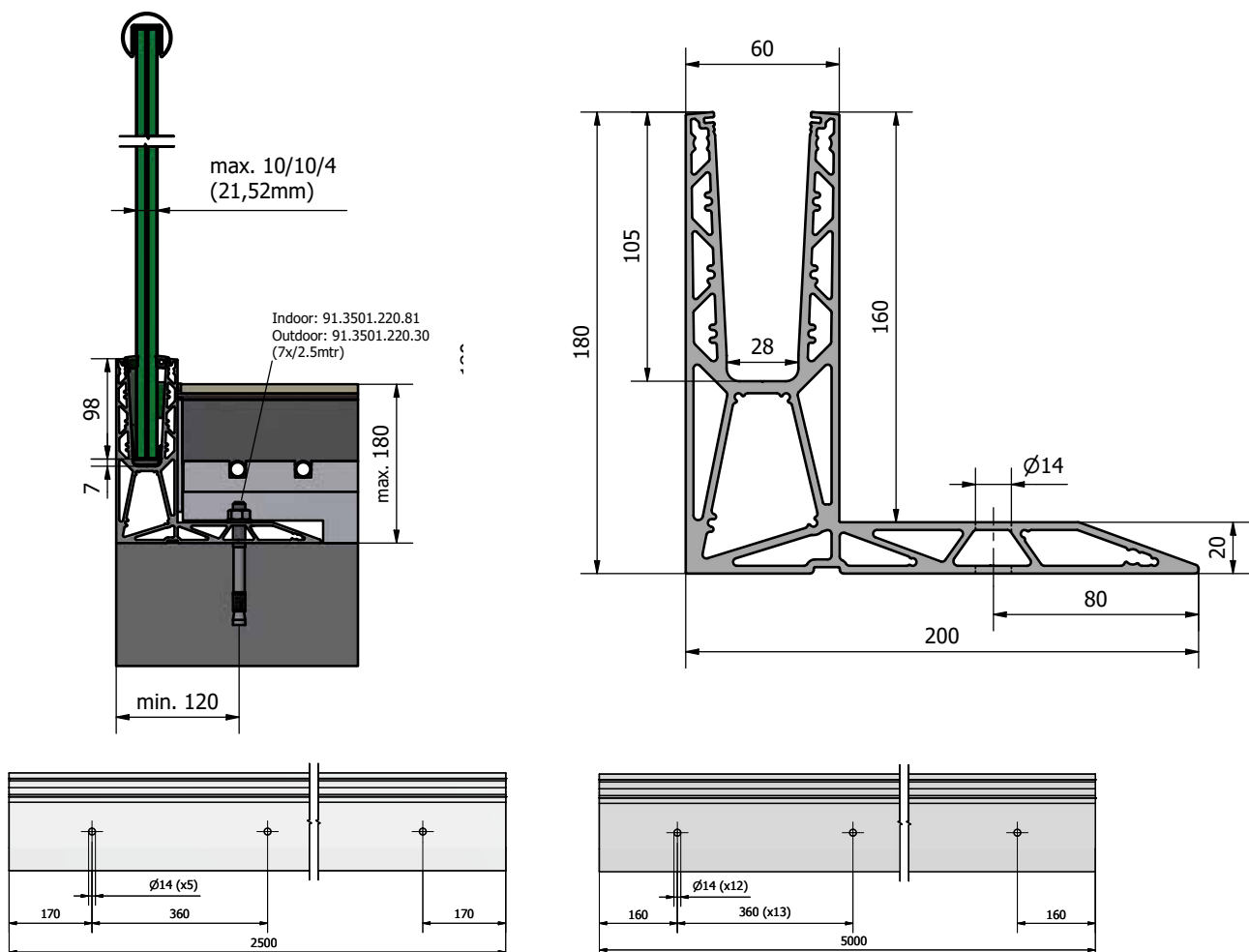



For higher floor structures
of up to 180 mm

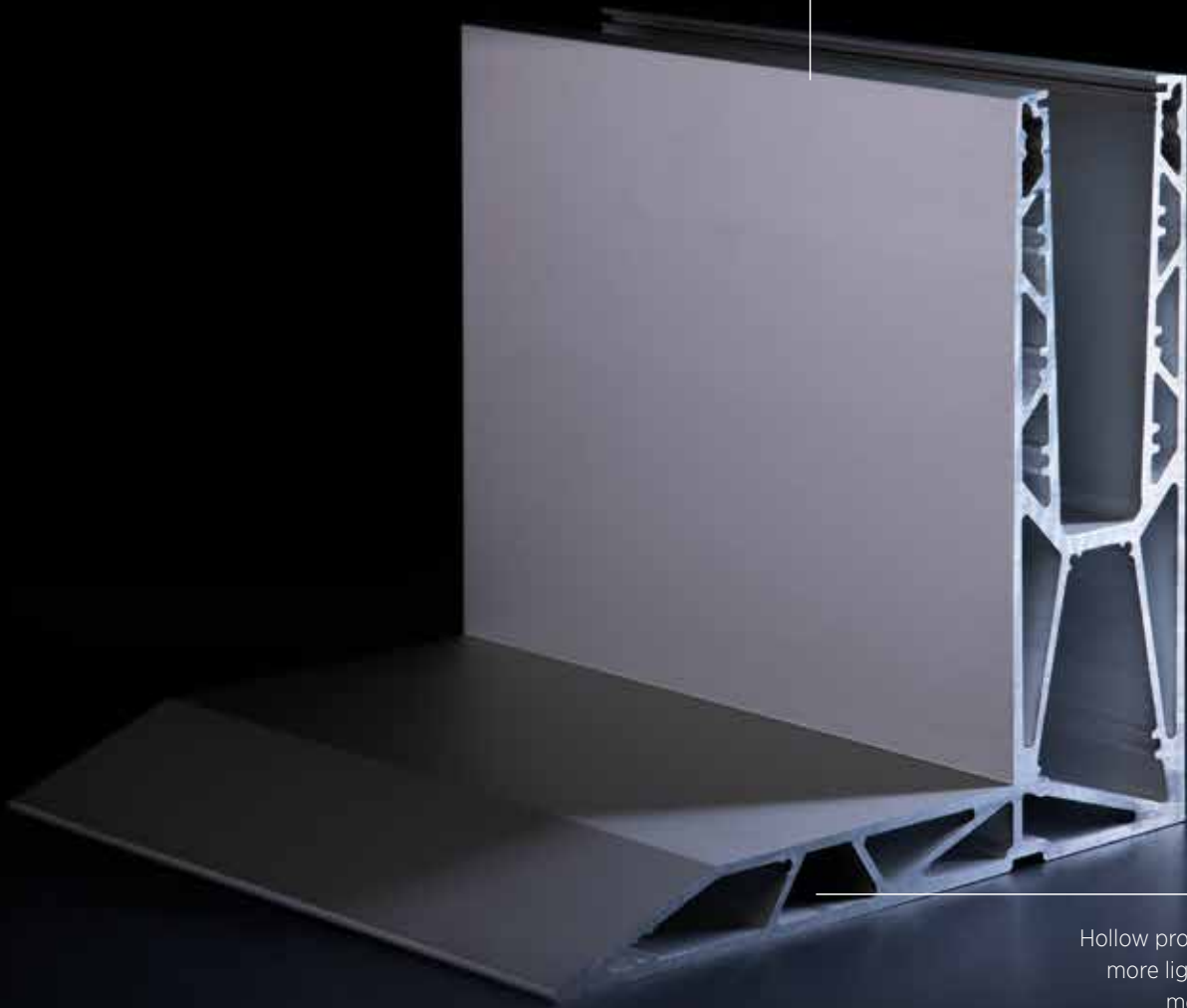

Hollow profile, therefore
more lightweight and
more economic



Top mount

TL-3120 | 0.74 KN TOP MOUNT

Glass profile



- | Height: 180 mm
- | Width 200 mm
- | Suitable for higher floor structures of up to 180 mm
- | Sales unit: 1 piece

Model 3120	Mill finish	Plain aluminium	RAL coloured
Length	Art. no.	Art. no.	Art. no.
2500	-	10.3120.002.11	-
5000	10.3120.005.10	10.3120.005.11	10.3120.005.13/16/18/19

Inside corner 90°



- | Side length inside: 50 mm
- | Side length outside: 250 mm
- | Sales unit: 1 piece

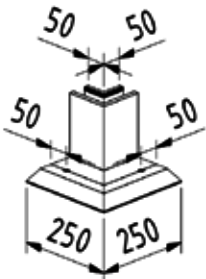

Model 3120	Mill finish	Plain aluminium	RAL coloured
	Art. no.	Art. no.	Art. no.
	10.3120.300.10	10.3120.300.11	10.3120.300.13/16/18/19

Outside corner 90°



- | Side length inside: 50 mm
- | Side length outside: 250 mm
- | Sales unit: 1 piece

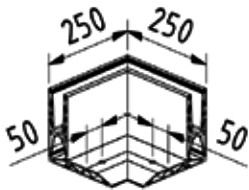

Model 3120	Mill finish	Plain aluminium	RAL coloured
	Art. no.	Art. no.	Art. no.
	10.3120.350.10	10.3120.350.11	10.3120.350.13/16/18/19

End cap



- | Sales unit: 1 piece

Model 3120	Mill finish	Plain aluminium	RAL coloured
Application	Art. no.	Art. no.	Art. no.
left	10.3120.400.10	10.3120.400.11	10.3120.400.13/16/18/19
right	10.3120.450.10	10.3120.450.11	10.3120.450.13/16/18/19

TL-3120 | 0.74 KN TOP MOUNT

Extension pin



- | Length: 40 mm
- | Diameter: Ø 6 mm
- | Sales unit: 8 pieces

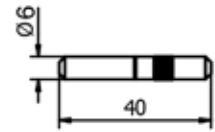

Model 7001	AISI 316 (inside & outside)
Art. no.	
90.7001.640.31	

Onlevel fixing anchor BZ 12-20-40/115

ONLEVEL

- | Finish interior application: Zinc-plated steel (inside)
- | Finish exterior application: V4A (exterior)
- | Required number per 2500 mm: 7 pieces
- | M12
- | Sales unit: 25 pieces



Model 3601	Zinc-plated steel (inside)	AISI 316 (exterior)
Art. no.		Art. no.
91.3601.220.81		91.3601.220.30

Fischer fixing anchor FAZ II 12/20

fischer

- | Finish interior application: zinc-plated steel (inside)
- | Finish exterior application: V4A (exterior)
- | Required number per 2500 mm: 7 pieces
- | M12
- | Sales unit: 20 pieces

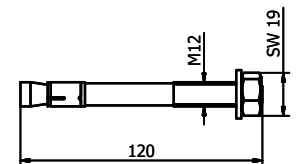

Model 3501	zinc-plated steel (inside)	AISI 316 (exterior)
Art. no.		Art. no.
91.3501.220.81		91.3501.220.30

Onlevel fixing anchor VMU-A 10-50/150

ONLEVEL

- | Finish interior application: zinc-plated steel (inside)
- | Finish exterior application: V4A (exterior)
- | Required number per 2500 mm: 13 pieces
- | Suitable mortar: 91.3600.010.00
- | Injection mortar (91.3600.010.00) is sufficient for ± 21 anchors
- | Sales unit: 10 pieces

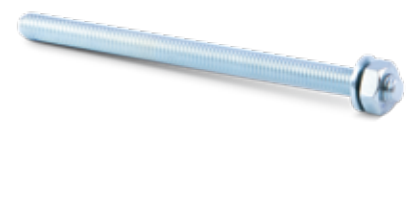

Model 3651	zinc-plated steel (inside)	AISI 316 (exterior)
Art. no.		Art. no.
91.3651.015.81		91.3651.015.30

TL-3120 | 0.74 kN TOP MOUNT

Fischer fixing anchor FIS A M10x150



- | Finish interior application: zinc-plated steel (inside)
- | Finish exterior application: V4A (exterior)
- | Required number per 5000 mm: 25 pieces (exterior), 13 pieces (interior)
- | Suitable mortar: 91.3000.010.00
- | Injection mortar (91.3000.010.00) is sufficient for ± 26 anchors
- | Sales unit: 10 pieces

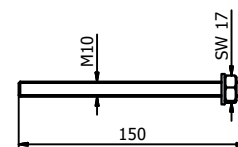

Model 3551	zinc-plated steel (inside)	AISI 316 (exterior)
Art. no.	Art. no.	Art. no.
91.3551.015.81		91.3551.015.30

Mounting set for steel



- | Finish interior application: zinc-plated steel (inside)
- | Finish exterior application: V4A (exterior)
- | Required number per 2500 mm: 7 pieces
- | M12 x 50 mm
- | Sales unit: 7 pieces

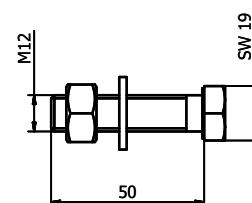

Model 3120	zinc-plated steel (inside)	AISI 316 (exterior)
Art. no.	Art. no.	Art. no.
91.3120.050.81		91.3120.050.30

FLEXFIT 1.0 kN



- | Fine adjustment of glass panes
- | For glass thicknesses between 12 - 21.52 mm
- | Adjustment of up to 34 mm in relation to the vertical axis
- | Pay attention to the right glass thickness!

Length		2500 mm	5000 mm	25 mtr
Glass thickness	Wedge colour	Art. no.	Art. no.	Art. no.
12 mm	black	-	90.0505.112.00	-
6/6/2 (12.76 mm)	red	90.0502.113.00	90.0505.113.00	90.0525.113.00
6/6/4 (13.52 mm)	grey	-	90.0505.114.00	-
8/8/2 (16.76 mm)	red	90.0502.117.00	90.0505.117.00	90.0525.117.00
8/8/4 (17.52 mm)	green	90.0502.118.00	90.0505.118.00	90.0525.118.00
10/10/2 (20.76 mm)	red	90.0502.121.00	90.0505.121.00	90.0525.121.00
10/10/4 (21.52 mm)	green	90.0502.122.00	90.0505.122.00	90.0525.122.00

ASSEMBLY TOOLS CAN BE FOUND IN THE ACCESSORIES CHAPTER



TL-3121

0.74 kN Side Mount

The higher level.

If you plan to aim even higher, the **TL-3121** is the right solution for you: Thanks to its diagonal connector as load support, the **TL-3121** Y-profile with its profile height of 300 mm for higher floor structures is especially suited for the lateral mounting of staircases. In addition, the **TL-3121** profile can optimally conceal thicker screed or insulation layers, as well as stair steps completely.

TL-3121 can withstand a linear load of 1.0 kN and is suitable for glass thicknesses between 12 mm and 21.52 mm.

Essential Features

- | Slimline, elegant design and low-maintenance
- | **ONLEVEL** FLEXFIT Glass Adjustment Tool
- | Drainage holes
- | Cover (optional)
- | Extension pin channels
- | For use with Top Cover 2.0 kN
- | Diagonal connector as load support
- | Integrated multifunctional sophisticated chamber
- | For higher floor structures
- | For glass thicknesses between 12 - 21.52 mm
- | Height adjustment with mounting block

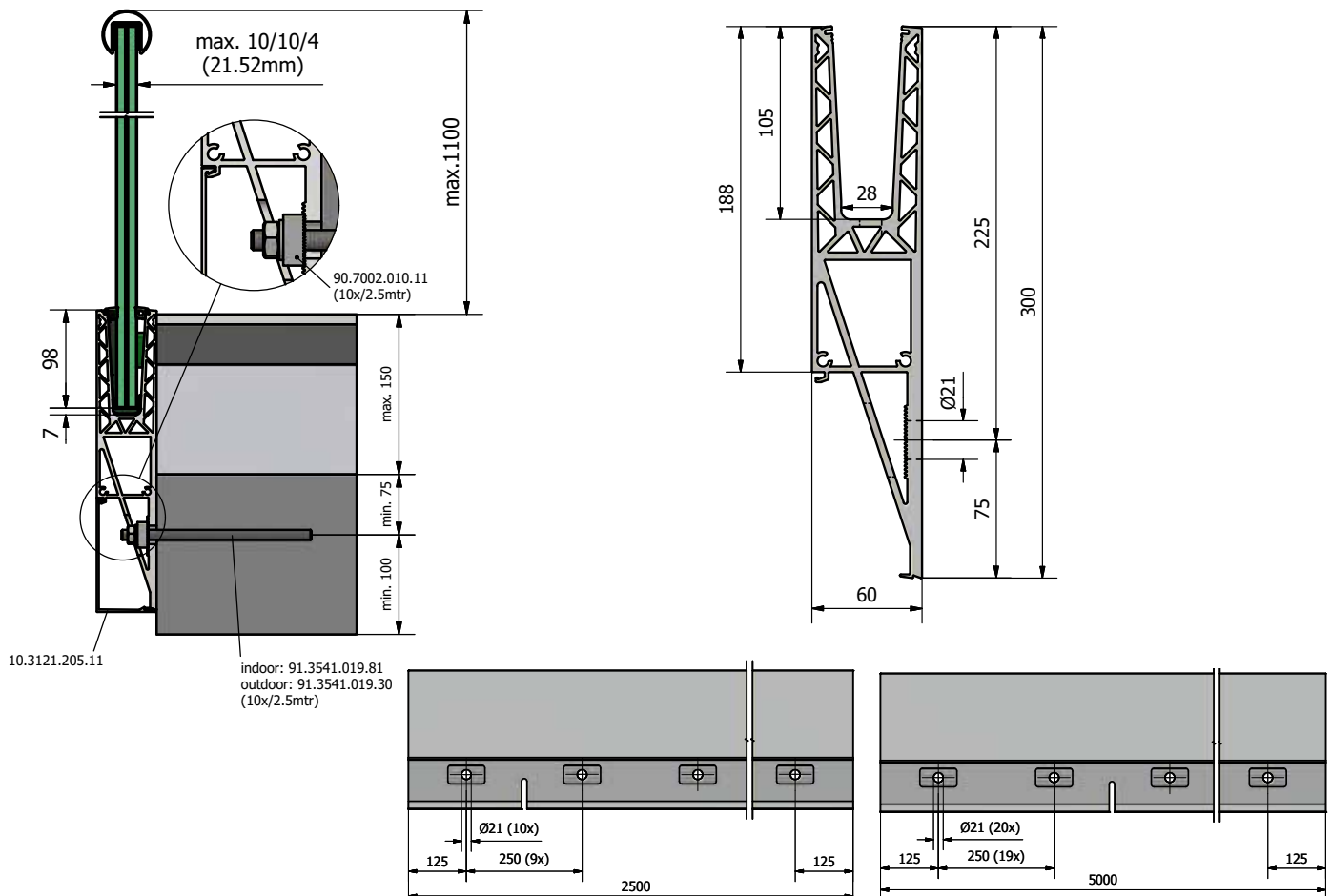



For higher floor structures
of up to 150 mm

Hollow profile, therefore
more lightweight and
more economic



Side Mount

Diagonal connector as load
support

TL-3121 | 0.74 KN SIDE MOUNT

Glass profile



- | Height: 300 mm
- | Width 60 mm
- | Suitable for higher floor structures of up to 150 mm
- | Sales unit: 1 piece

Model 3121	Mill finish	Plain aluminium	RAL coloured
Length	Art. no.	Art. no.	Art. no.
2500	-	10.3121.002.11	-
5000	10.3121.005.10	10.3121.005.11	10.3121.005.13/16/18/19

Inside corner 90°



- | Side length inside: 140 mm
- | Side length outside: 200 mm
- | Sales unit: 1 piece

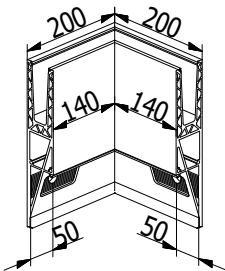

Model 3121	Mill finish	Plain aluminium	RAL coloured
	Art. no.	Art. no.	Art. no.
	10.3121.300.10	10.3121.300.11	10.3121.300.13/16/18/19

Outside corner 90°



- | Side length inside: 140 mm
- | Side length outside: 200 mm
- | Sales unit: 1 piece

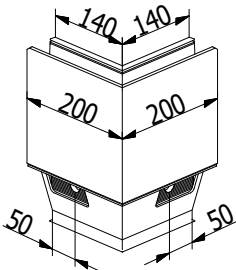

Model 3121	Mill finish	Plain aluminium	RAL coloured
	Art. no.	Art. no.	Art. no.
	10.3121.350.10	10.3121.350.11	10.3121.350.13/16/18/19

Cover Cap for interior applications



- | For using the TL3121 profile in interior fit-out applications
- | Sales unit: 1 piece

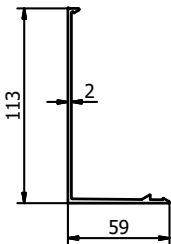

Model 3121	Mill finish	Plain aluminium	RAL coloured
Length	Art. no.	Art. no.	Art. no.
2500	-	10.3121.202.11	-
5000	10.3121.205.10	10.3121.205.11	10.3121.205.13/16/18/19

TL-3121 | 0.74 KN SIDE MOUNT

Cover Cap for exterior applications



| For using the TL3121 profile in exterior applications
| Sales unit: 1 piece

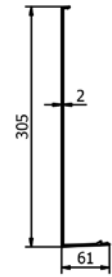

Model 3121	Mill finish	Plain aluminium	RAL coloured
Length	Art. no.	Art. no.	Art. no.
2500	-	10.3121.212.11	-
5000	10.3121.215.10	10.3121.215.11	10.3121.215.13/16/18/19

End cap with cover strip, Interior



| Sales unit: 1 piece

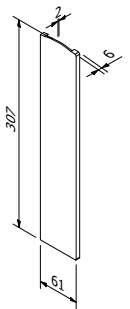

Model 3121	Mill finish	Plain aluminium	RAL coloured
Application	Art. no.	Art. no.	Art. no.
left - Interior	10.3121.410.10	10.3121.410.11	10.3121.410.13/16/18/19
right - Interior	10.3121.460.10	10.3121.460.11	10.3121.460.13/16/18/19

End cap with cover strip, Exterior



| Sales unit: 1 piece

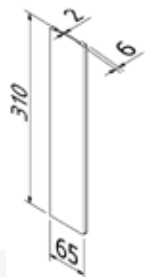

Model 3121	Mill finish	Plain aluminium	RAL coloured
Application	Art. no.	Art. no.	Art. no.
left - Exterior	10.3121.415.10	10.3121.415.11	10.3121.415.13/16/18/19
right - Exterior	10.3121.465.10	10.3121.465.11	10.3121.465.13/16/18/19

End cap with cover cap for staircase, interior



| Sales unit: 1 piece

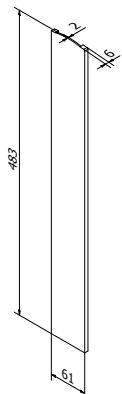

Model 3121	Mill finish	Plain aluminium	RAL coloured
Application	Art. no.	Art. no.	Art. no.
left	10.3121.411.10	10.3121.411.11	10.3121.411.13/16/18/19
right	10.3121.461.10	10.3121.461.11	10.3121.461.13/16/18/19

TL-3121 | 0.74 KN SIDE MOUNT

Mounting block



- | Required number per 2500 mm: 10 pieces
- | Sales unit: 8 pieces

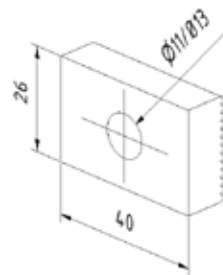

Model 7022	Plain aluminium
Inner drill hole	Art. no.
Ø 11 mm	90.7022.010.11
Ø 13 mm	90.7022.012.11

Extension pin



- | Length: 40 mm
- | Diameter: Ø 6 mm
- | Sales unit: 8 pieces



Model 7001	AISI 316 (inside & outside)
	Art. no.
	90.7001.640.31

Onlevel fixing anchor VMU-A 10x190

ONLEVEL



- | Finish interior application: zinc-plated steel (inside)
- | Finish exterior application: V4A (exterior)
- | Required number per 2500 mm: 7 pieces
- | M10
- | Suitable mortar: 91.3600.010.00
- | Injection mortar (91.3600.010.00) is sufficient for ± 18 anchors
- | Sales unit: 10 pieces

Model 3641	zinc-plated steel (inside)	AISI 316 (exterior)
	Art. no.	Art. no.
	91.3641.019.81	91.3641.019.30

Fischer fixing anchor RG M10x190

fischer 



- | Finish interior application: zinc-plated steel (inside)
- | Finish exterior application: V4A (exterior)
- | Required number per 2500 mm: 10 pieces
- | M10
- | Suitable mortar: 91.3000.010.00
- | Injection mortar (91.3000.010.00) is sufficient for ± 22 anchors
- | Sales unit: 10 pieces

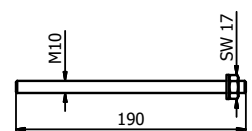

Model 3541	zinc-plated steel (inside)	AISI 316 (exterior)
	Art. no.	Art. no.
	91.3541.019.81	91.3541.019.30

TL-3121 | 0.74 KN SIDE MOUNT

Mounting set for steel



- | Finish interior application: zinc-plated steel (inside)
- | Finish exterior application: V4A (exterior)
- | Required number per 2500 mm: 10 pieces
- | M10 x 60mm
- | Sales unit: 10 pieces

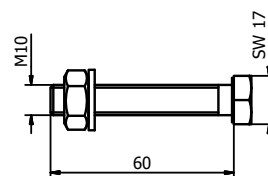

Model 3121	zinc-plated steel (inside)	AISI 316 (exterior)
	Art. no.	Art. no.
	91.3121.060.81	91.3121.060.30

FLEXFIT 1.0 KN



- | Fine adjustment of glass panes
- | For glass thicknesses between 12 - 21.52 mm
- | Adjustment of up to 34 mm in relation to the vertical axis
- | Pay attention to the right glass thickness!

Length		2500 mm	5000 mm	25 mtr
Glass thickness	Wedge colour	Art. no.	Art. no.	Art. no.
12 mm	black	-	90.0505.112.00	-
6/6/2 (12.76 mm)	red	90.0502.113.00	90.0505.113.00	90.0525.113.00
6/6/4 (13.52 mm)	grey	-	90.0505.114.00	-
8/8/2 (16.76 mm)	red	90.0502.117.00	90.0505.117.00	90.0525.117.00
8/8/4 (17.52 mm)	green	90.0502.118.00	90.0505.118.00	90.0525.118.00
10/10/2 (20.76 mm)	red	90.0502.121.00	90.0505.121.00	90.0525.121.00
10/10/4 (21.52 mm)	green	90.0502.122.00	90.0505.122.00	90.0525.122.00

ASSEMBLY TOOLS CAN BE FOUND IN THE ACCESSORIES CHAPTER

SEALING OF BALUSTRADE SYSTEMS

Attention, this is the OnLevel Water Police speaking. Your building is leaking!

This is exactly the challenge we are facing. There are manufacturers who really believe that this issue can be solved with a base profile. Never ever, my friends. We have counted exactly 987,339 different applications. That is why we need to be as flexible as possible to be ready to adapt to the most diverse conditions. This is where the modular principle comes into play. Please see in the following figure what our drainage holes look like and which path the water takes. Here, we need a proper seal.

And of course, we have some possible solutions for you.





ONLEVEL

ONLEVEL Ltd. | Unit 7, Alexandria Court | Alexandria Drive
Ashton Commerce Park | Ashton-under-Lyne | Lancashire OL7 0QN | United Kingdom
T +44 0161 804 9500 | F +44 0161 804 9505 | info@onlevel-uk.com | www.onlevel.com