

ONLEVEL

TL60**20** - TL60**21**
SYSTEMS FOR FRAMELESS
ALL-GLASS BALUSTRADES

TL-6020

1.0 kN Top Mount

Level Up.

The TL-6020 U-profile is the intelligent onward development of the TL-6010 profile. Here the outstanding feature consists in the increase of mounting distances, which now enables the use of the profile also on an anchor bolt without countersunk head. Therefore, mounting the product is not only faster and more cost efficient, but also statics have improved considerably.

It can be used in exterior applications, withstands a linear load of 1.0 kN and is appropriate for glass thicknesses between 12 mm and 21.52 mm.

Essential Features

- | Slimline, elegant design and low-maintenance
- | **ONLEVEL** FLEXFIT Glass Adjustment Tool
- | Extension pin holes
- | Drainage holes
- | For use with Top Cover 3.0 kN
- | For glass thicknesses between 12 - 21.52 mm
- | For applications of 1.0 kN in private areas, the mounting distance amounts to 60 cm



TESTED
according to
BS6180

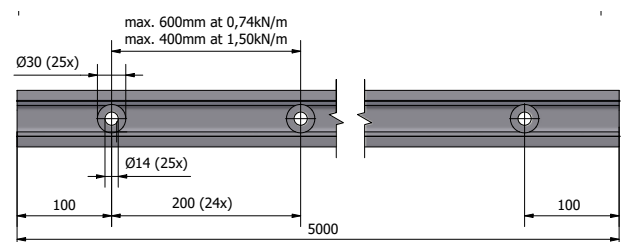
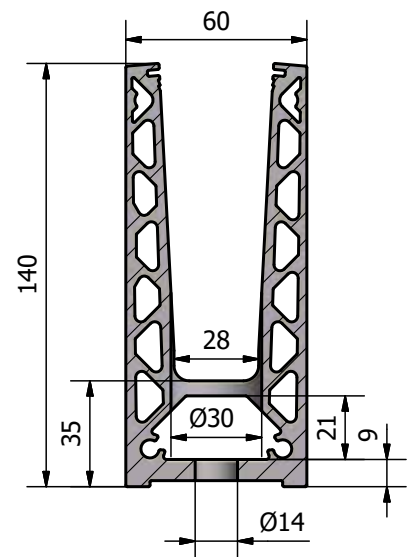
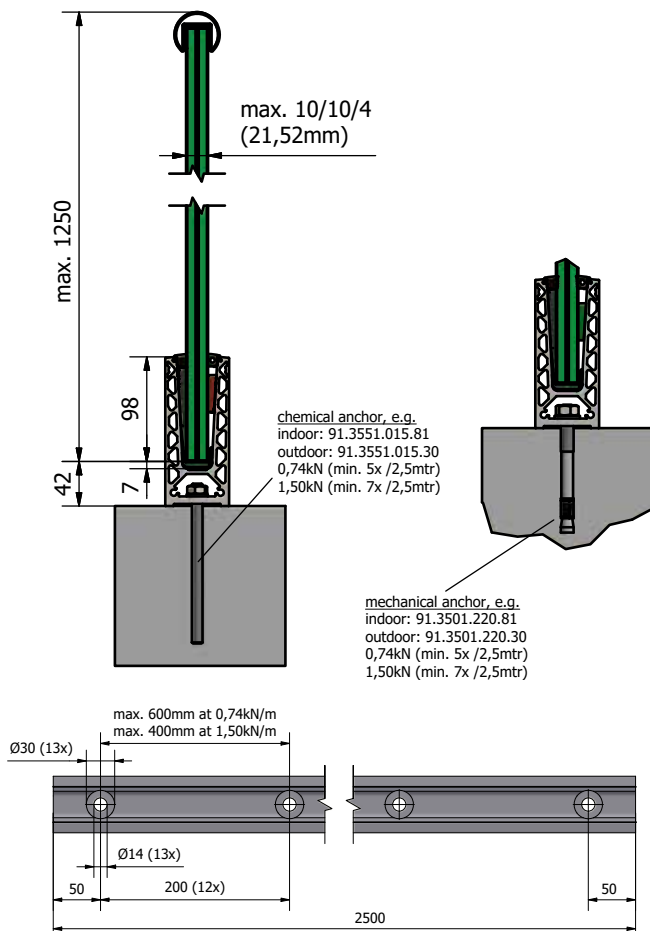



Increased stability with the
same looks



Integrated multifunctional
sophisticated chamber for
enabling larger drilling distances



Top mount

TL-6020 | 1.0 KN TOP MOUNT

Glass profile



| Height: 140 mm
| Width: 60 mm
| Sales unit: 1 piece

| Model 6020 | Mill finish | Plain aluminium | RAL coloured |
|------------|----------------|-----------------|-------------------------|
| Length | Art. no. | Art. no. | Art. no. |
| 2500 | 10.6020.002.10 | 10.6020.002.11 | - |
| 5000 | 10.6020.005.10 | 10.6020.005.11 | 10.6020.005.13/16/18/19 |

Inside corner / outside corner 90°



| Side length inside: 140 mm
| Side length outside: 200 mm
| Sales unit: 1 piece

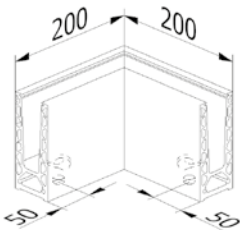

| Model 6020 | Mill finish | Plain aluminium | RAL coloured |
|------------|----------------|-----------------|-------------------------|
| | Art. no. | Art. no. | Art. no. |
| | 10.6020.390.10 | 10.6020.390.11 | 10.6020.390.13/16/18/19 |

End cap, left/right



| For use on the left and right
| Sales unit: 1 piece

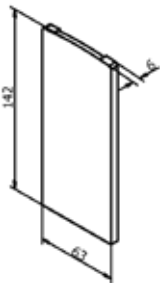

| Model 6020 | Mill finish | Plain aluminium | RAL coloured |
|-------------|----------------|-----------------|-------------------------|
| Application | Art. no. | Art. no. | Art. no. |
| left/right | 10.6020.490.10 | 10.6020.490.11 | 10.6020.490.13/16/18/19 |

End cap for staircase, left/right



| For use on the left and right
| cut-to-size
| Sales unit: 1 piece



| Model 6020 | Mill finish | Plain aluminium | RAL coloured |
|-------------|----------------|-----------------|-------------------------|
| Application | Art. no. | Art. no. | Art. no. |
| left/right | 10.6020.491.10 | 10.6020.491.11 | 10.6020.491.13/16/18/19 |

TL-6020 | 1.0 KN TOP MOUNT

Spacer



You do not have any drainage options on your balcony?!
So that you do not need to install a dam on your balcony, you can simply mount the spacers beneath your profile.

- | Inner drill hole: Ø 14 mm
- | Sales unit: 13 pieces

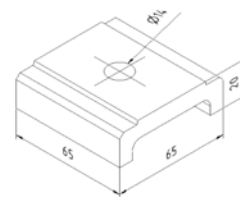

| Model 6020 | Mill finish | Plain aluminium | RAL coloured |
|------------|----------------|-----------------|-------------------------|
| | Art. no. | Art. no. | Art. no. |
| | 10.6020.500.10 | 10.6020.500.11 | 10.6020.500.13/16/18/19 |

Extension pin



- | Length: 40 mm
- | Diameter: Ø 6 mm
- | Sales unit: 8 piece

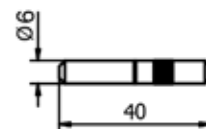

| Model 7001 | AISI 316 (inside & outside) |
|------------|-----------------------------|
| | Art. no. |
| | 90.7001.640.31 |

Fischer fixing anchor FIS AM M10x150



- | Finish interior application: zinc-plated steel (inside)
- | Finish exterior application: V4A (exterior)
- | Required number per 2500 mm: 13 pieces
- | Suitable mortar: 91.3000.010.00
- | Injection mortar (91.3000.010.00) is sufficient for ± 26 anchors
- | Sales unit: 10 pieces

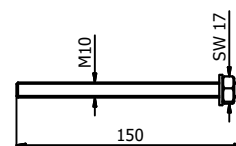

| Model 3551 | zinc-plated steel (inside) | AISI 316 (exterior) |
|------------|----------------------------|---------------------|
| | Art. no. | Art. no. |
| | 91.3551.015.81 | 91.3551.015.30 |

Fixing anchor steel



- | Finish interior application: zinc-plated steel (inside)
- | Finish exterior application: V4A (exterior)
- | Required number per 2500 mm: 13 pieces
- | M10 x 60 mm
- | Sales unit: 25 pieces

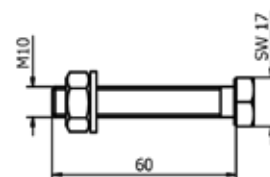

| Model 6020 | zinc-plated steel (inside) | AISI 316 (exterior) |
|------------|----------------------------|---------------------|
| | Art. no. | Art. no. |
| | 91.6020.060.81 | 91.6020.060.30 |

TL-6020 | 1.0 KN TOP MOUNT

Fischer fixing anchor FAZ II 12/10



- | Finish interior application: zinc-plated steel (inside)
- | Finish exterior application: V4A (exterior)
- | Required number per 2500 mm: 13 pieces
- | Sales unit: 20 pieces

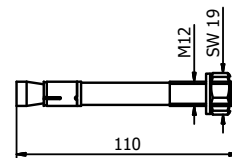

| Model 3501 | zinc-plated steel (inside) | AISI 316 (exterior) |
|----------------|----------------------------|---------------------|
| Art. no. | Art. no. | Art. no. |
| 91.3501.210.30 | | 91.3501.210.81 |

Screw anchor for concrete

- | Suitable for our profiles without countersinking
- | Finish interior application: Zinc-plated steel (interior) HUS4-H 10x90
- | Finish exterior application: V4A (outside) HUS4-HR 10x95
- | Tangential screwdriver required
- | Required number per 2500 mm: 13 pieces

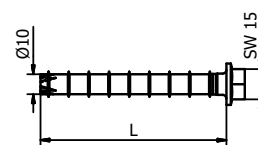

| Model 3701 | zinc-plated steel (inside) | Model 3701 | AISI 316 (exterior) |
|------------|----------------------------|------------|---------------------|
| Sales unit | Art. no. | Sales unit | Art. no. |
| 50 | 91.3701.090.81 | 25 | 91.3701.095.30 |

FLEXFIT 1.0 kN



- | Fine adjustment of glass panes
- | For glass thicknesses between 12 - 21.52 mm
- | Adjustment of up to 34 mm in relation to the vertical axis
- | Pay attention to the right glass thickness!

| Length | | 2500 mm | 5000 mm | 25 mtr |
|---------------------------|--------------|----------------|----------------|----------------|
| Glass thickness | Wedge colour | Art. no. | Art. no. | Art. no. |
| 12 mm | black | - | 90.0505.112.00 | - |
| 6/6/2 (12.76 mm) | red | 90.0502.113.00 | 90.0505.113.00 | 90.0525.113.00 |
| 6/6/4 (13.52 mm) | grey | - | 90.0505.114.00 | - |
| 8/8/2 (16.76 mm) | red | 90.0502.117.00 | 90.0505.117.00 | 90.0525.117.00 |
| 8/8/4 (17.52 mm) | green | 90.0502.118.00 | 90.0505.118.00 | 90.0525.118.00 |
| 10/10/2 (20.76 mm) | red | 90.0502.121.00 | 90.0505.121.00 | 90.0525.121.00 |
| 10/10/4 (21.52 mm) | green | 90.0502.122.00 | 90.0505.122.00 | 90.0525.122.00 |

TAKE A LITTLE DISTANCE – WITH OUR SPACER.

Hoover Dam is a thing of the past. There is more water on balconies than in the legendary dammed Colorado River. We have the suitable spacer for every profile to keep your feet dry. In addition, our spacers are constructed such as to adapt themselves to all static conditions.

10.xxxx.500.xx

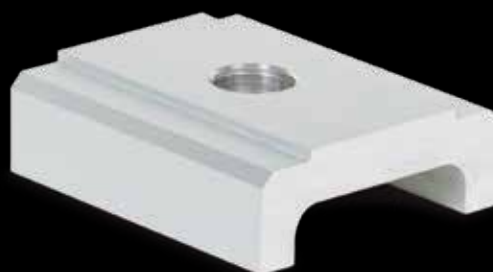

TL-6021

1.0 kN Side Mount

The Evolution Goes On.

The TL-6021 U-profile is the intelligent onward development of the TL-6011 profile. Here the outstanding feature consists in the increase of mounting distances, which now enables the use of the profile also on an anchor bolt without countersunk head. This makes mounting the product not only much quicker and more cost efficient, also statics have improved significantly.

The TL-6021 U-profile can be used for exterior applications. It can withstand a linear load of 1.0 kN and is appropriate for glass thicknesses between 12 mm and 21.52 mm.

Essential Features

- | Slimline, elegant design and low-maintenance
- | **ONLEVEL** FLEXFIT Glass Adjustment Tool
- | Drainage holes
- | Cover (optional)
- | For use with Top Cover 3.0 kN
- | For glass thicknesses between 12 mm and 21.52 mm
- | For applications of 0 1.0kN in private areas, the mounting distance amounts to 40 cm

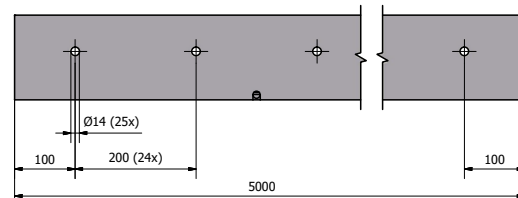
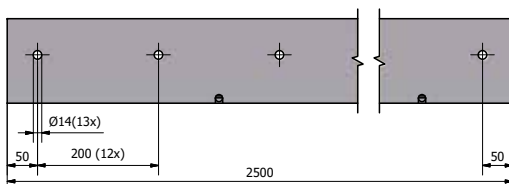
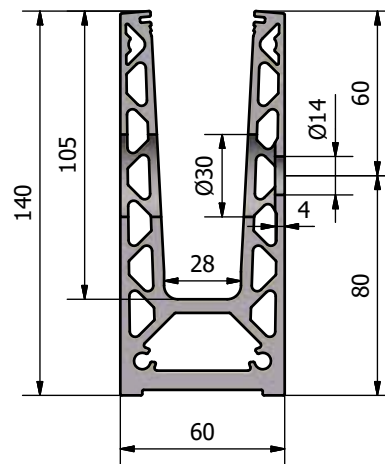
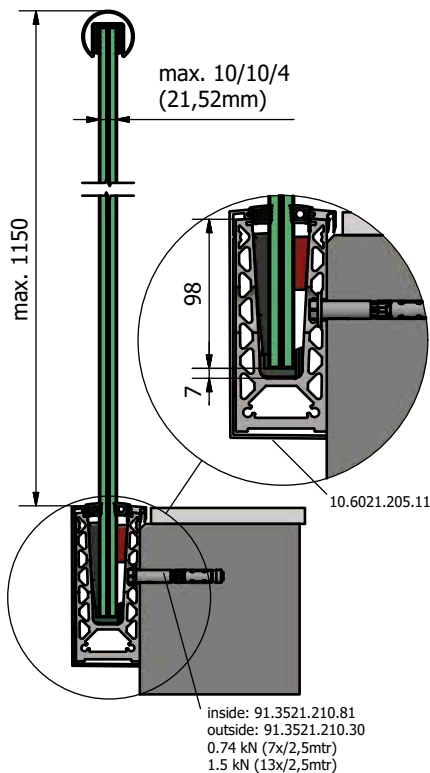



Improved statics

Can be anchored universally
depending on the application



Side mount

Integrated multifunctional
sophisticated chamber for
enabling larger drilling
distances

TL-6021 | 1.0 KN SIDE MOUNT

Glass profile



| Height: 140 mm
| Width: 60 mm
| Sales unit: 1 piece

| Model 6021 | Mill finish | Plain aluminium | RAL coloured |
|------------|----------------|-----------------|-------------------------|
| Length | Art. no. | Art. no. | Art. no. |
| 2500 | - | 10.6021.002.11 | - |
| 5000 | 10.6021.005.10 | 10.6021.005.11 | 10.6021.005.13/16/18/19 |

Inside corner 90°



| Side length inside: 140 mm
| Side length outside: 200 mm
| Sales unit: 1 piece

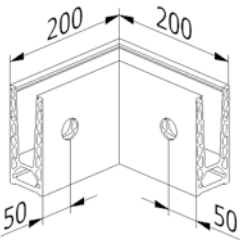

| Model 6021 | Mill finish | Plain aluminium | RAL coloured |
|------------|----------------|-----------------|-------------------------|
| | Art. no. | Art. no. | Art. no. |
| | 10.6021.300.10 | 10.6021.300.11 | 10.6021.300.13/16/18/19 |

Outside corner 90°



| Side length inside: 140 mm
| Side length outside: 200 mm
| Sales unit: 1 piece

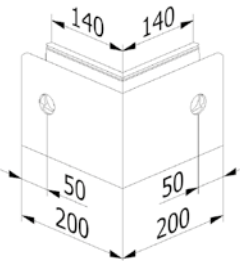

| Model 6021 | Mill finish | Plain aluminium | RAL coloured |
|------------|----------------|-----------------|-------------------------|
| | Art. no. | Art. no. | Art. no. |
| | 10.6021.350.10 | 10.6021.350.11 | 10.6021.350.13/16/18/19 |

Cover Cap



| With mounting strips
| For use with a Cover Cap, end caps must be ordered separately
| Sales unit: 1 piece



| Model 6021 | Mill finish | Plain aluminium | RAL coloured |
|------------|----------------|-----------------|-------------------------|
| Length | Art. no. | Art. no. | Art. no. |
| 2500 | - | 10.6021.202.11 | - |
| 5000 | 10.6021.205.10 | 10.6021.205.11 | 10.6021.205.13/16/18/19 |

TL-6021 | 1.0 KN SIDE MOUNT

End cap, left



| For use on the left
| Sales unit: 1 piece

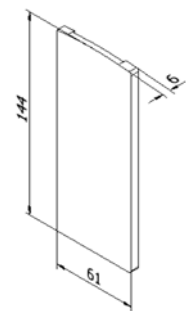

| Model 6021 | Mill finish | Plain aluminium | RAL coloured |
|-------------|----------------|-----------------|-------------------------|
| Application | Art. no. | Art. no. | Art. no. |
| left | 10.6021.400.10 | 10.6021.400.11 | 10.6021.400.13/16/18/19 |

End cap, right



| For use on the right
| Sales unit: 1 piece

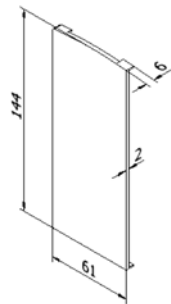

| Model 6021 | Mill finish | Plain aluminium | RAL coloured |
|-------------|----------------|-----------------|-------------------------|
| Application | Art. no. | Art. no. | Art. no. |
| right | 10.6021.450.10 | 10.6021.450.11 | 10.6021.450.13/16/18/19 |

End cap, left, with Cover Cap



| For use on the left
| Sales unit: 1 piece

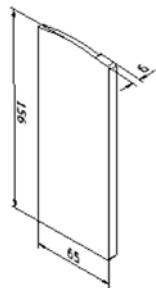

| Model 6021 | Mill finish | Plain aluminium | RAL coloured |
|-------------|----------------|-----------------|-------------------------|
| Application | Art. no. | Art. no. | Art. no. |
| left | 10.6021.410.10 | 10.6021.410.11 | 10.6021.410.13/16/18/19 |

End cap, right, with Cover Cap



| For use on the right
| Sales unit: 1 piece

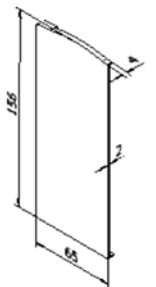

| Model 6021 | Mill finish | Plain aluminium | RAL coloured |
|-------------|----------------|-----------------|-------------------------|
| Application | Art. no. | Art. no. | Art. no. |
| right | 10.6021.460.10 | 10.6021.460.11 | 10.6021.460.13/16/18/19 |

TL-6021 | 1.0 KN SIDE MOUNT

End cap for staircase with Cover Cap, left



- | For use on the left
- | can be cut to size
- | Sales unit: 1 piece



| Model 6021 | Mill finish | Plain aluminium | RAL coloured |
|-------------|----------------|-----------------|-------------------------|
| Application | Art. no. | Art. no. | Art. no. |
| left | 10.6021.411.10 | 10.6021.411.11 | 10.6021.411.13/16/18/19 |

End cap for staircase with Cover Cap, right



- | For use on the right
- | can be cut to size
- | Sales unit: 1 piece



| Model 6021 | Mill finish | Plain aluminium | RAL coloured |
|-------------|----------------|-----------------|-------------------------|
| Application | Art. no. | Art. no. | Art. no. |
| right | 10.6021.461.10 | 10.6021.461.11 | 10.6021.461.13/16/18/19 |

Spacer



- | Thickness: 15 mm
- | Sales unit: 13 pieces

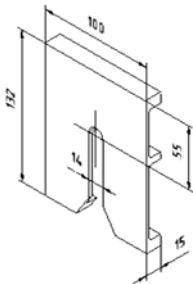

| Model 6021 | Mill finish | Plain aluminium | RAL coloured |
|------------|----------------|-----------------|-------------------------|
| | Art. no. | Art. no. | Art. no. |
| | 10.6021.500.10 | 10.6021.500.11 | 10.6021.500.13/16/18/19 |

Blanking plug



- | Required number per 2500 mm: 17 pieces
- | Sales unit: 10 pieces

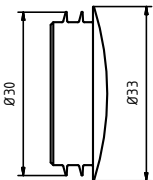

| Model 7000 | | Plastic |
|------------|----------|----------------|
| Colour | Diameter | Art. no. |
| white | 30 mm | 90.7000.030.40 |
| black | 30 mm | 90.7000.030.41 |
| grey | 30 mm | 90.7000.030.45 |

TL-6021 | 1.0 KN SIDE MOUNT

Extension pin



- | Length: 40 mm
- | Diameter: Ø 6 mm
- | Sales unit: 8 piece



| Model 7001 | AISI 316 (inside & outside) |
|----------------|-----------------------------|
| Art. no. | |
| 90.7001.640.31 | |

Fischer fixing anchor FH II 12/10



- | Finish interior application: zinc-plated steel (inside)
- | Finish exterior application: V4A (exterior)
- | Required number per 2500 mm: 13 pieces
- | Sales unit: 50 pieces

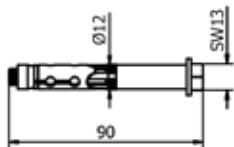

| Model 3521 | zinc-plated steel (inside) | AISI 316 (exterior) |
|----------------|----------------------------|---------------------|
| Art. no. | | Art. no. |
| 91.3521.210.81 | | 91.3521.210.30 |

Mounting set for steel



- | Finish interior application: zinc-plated steel (inside)
- | Finish exterior application: V4A (exterior)
- | Required number per 2500 mm: 13 pieces
- | M10 x 60 mm
- | Sales unit: 13 pieces

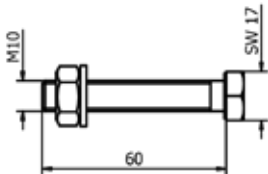

| Model 6021 | zinc-plated steel (inside) | AISI 316 (exterior) |
|----------------|----------------------------|---------------------|
| Art. no. | | Art. no. |
| 91.6021.060.81 | | 91.6021.060.30 |

Mounting set for wood



- | Finish interior application: zinc-plated steel (inside)
- | Required number per 2500 mm: 13 pieces
- | M12
- | Sales unit: 13 pieces

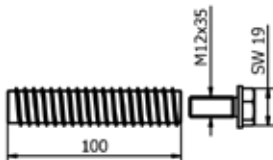

| Model 6021 | zinc-plated steel (inside) |
|----------------|----------------------------|
| Art. no. | |
| 91.6021.800.81 | |



TL-6021 | 1.0 KN SIDE MOUNT

Screw anchor for concrete



- | Suitable for our profiles without countersinking
- | Finish interior application: Zinc-plated steel (interior) HUS4-H 10x90
- | Finish exterior application: V4A (outside) HUS4-HR 10x95
- | Tangential screwdriver required
- | Required number per 2500 mm: 13 pieces

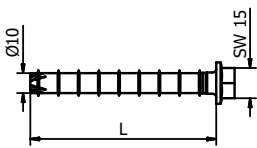

| Model 3701 | zinc-plated steel (inside) | Model 3701 | AISI 316 (exterior) |
|------------|----------------------------|------------|---------------------|
| Sales unit | Art. no. | Sales unit | Art. no. |
| 50 | 91.3701.090.81 | 25 | 91.3701.095.30 |

FLEXFIT 1.0 KN



- | Fine adjustment of glass panes
- | For glass thicknesses between 12 - 21.52 mm
- | Adjustment of up to 34 mm in relation to the vertical axis
- | Pay attention to the right glass thickness!

| Length | | 2500 mm | 5000 mm | 25 mtr |
|--------------------|--------------|----------------|----------------|----------------|
| Glass thickness | Wedge colour | Art. no. | Art. no. | Art. no. |
| 12 mm | black | - | 90.0505.112.00 | - |
| 6/6/2 (12.76 mm) | red | 90.0502.113.00 | 90.0505.113.00 | 90.0525.113.00 |
| 6/6/4 (13.52 mm) | grey | - | 90.0505.114.00 | - |
| 8/8/2 (16.76 mm) | red | 90.0502.117.00 | 90.0505.117.00 | 90.0525.117.00 |
| 8/8/4 (17.52 mm) | green | 90.0502.118.00 | 90.0505.118.00 | 90.0525.118.00 |
| 10/10/2 (20.76 mm) | red | 90.0502.121.00 | 90.0505.121.00 | 90.0525.121.00 |
| 10/10/4 (21.52 mm) | green | 90.0502.122.00 | 90.0505.122.00 | 90.0525.122.00 |

DRAINAGE – BUT NOT A RAIN GUTTER.

If water and cold combine, this can lead to problems when using all-glass balustrades. For this purpose, all **ONLEVEL** glass support profiles are equipped with drainage holes with a distance of 1000 mm between each of them. And we wouldn't be **ONLEVEL**, if we hadn't thought of all sorts of situations. Depending on the season, the balustrade can be subject to the most different influences (e.g.: leaves, sand, dirt).

We offer the only profile of this kind on the market.

ONLEVEL has paid special attention to ensure that the pivot point of the glass is on the same level as the rubber seals – therefore the rubber seals are never directly subjected to an increased or decreased load. As a result, dirt affects the balustrade much less.

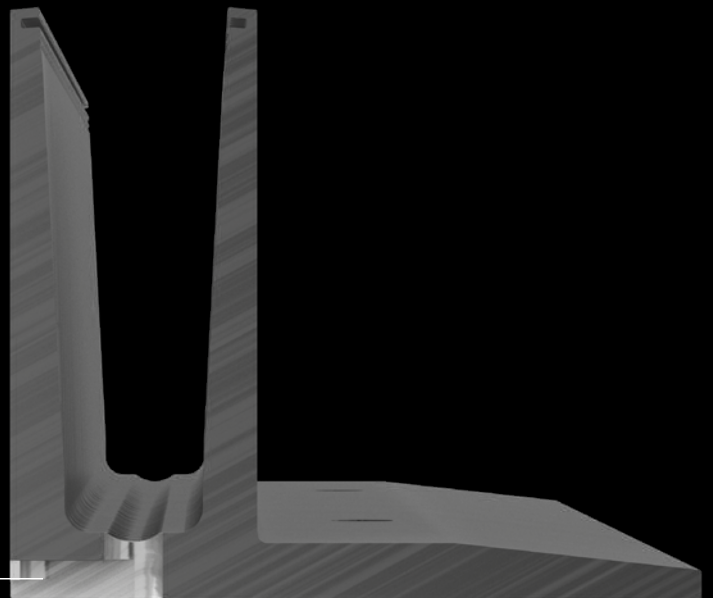

TL3010

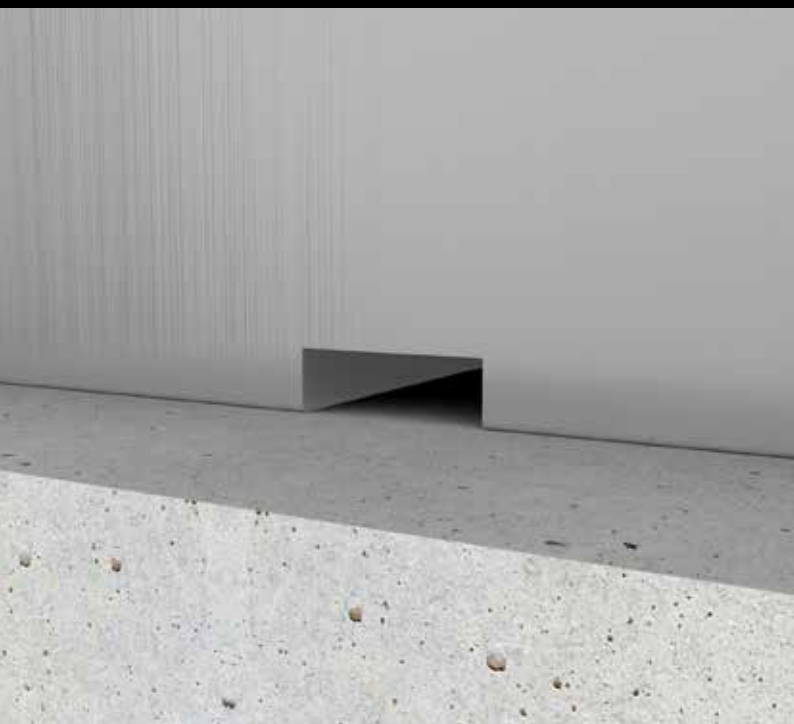



ONLEVEL

ONLEVEL Ltd. | Units 7, Alexandria Court | Alexandria Drive
Ashton Commerce Park | Ashton-under-Lyne | Lancashire OL7 0QN | United Kingdom
T +44 0161 804 9500 | F +44 0161 804 9505 | info@onlevel-uk.com | www.onlevel.com