A photograph of a modern building's exterior. The focus is on a balcony with a glass railing system. The railing consists of glass panels held in place by metal clamps. The building has a light-colored facade and large windows. A dark metal frame is visible on the roof. The sky is overcast.

ONLEVEL

GLASS CLAMPS  
**GLASS CLAMP SYSTEMS  
WITH ABP CERTIFICATE**

# GLASS CLAMPS

Glass clamp systems with AbP certificate

## Glass clamps

Don't get clamped – ensure everything stays where it belongs.

## Essential Features

- | Stainless steel clamps in V2A and V4A
- | Suitable for glass of 8-12.76 mm thick
- | Security pin and plate available
- | Mounting flat and 42.4 mm radius
- | Models 5300 and 5310 can be combined

## Model 5100

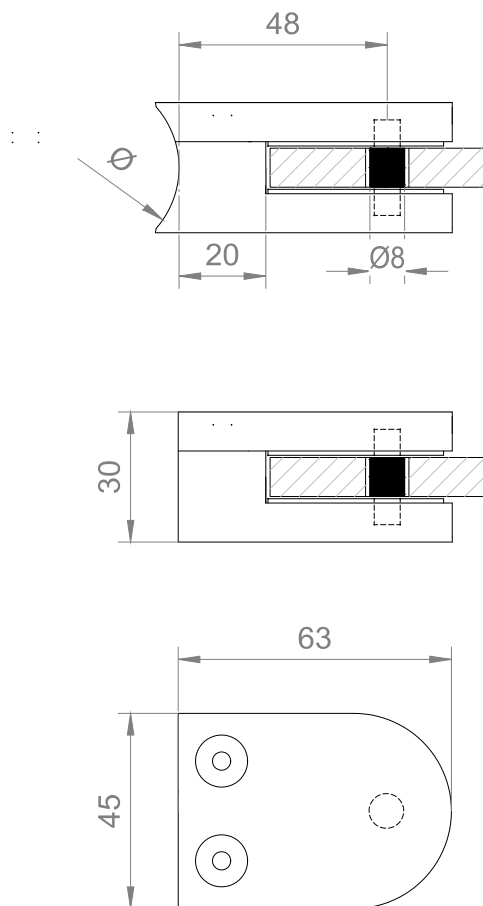

## Model 5300\*/5310

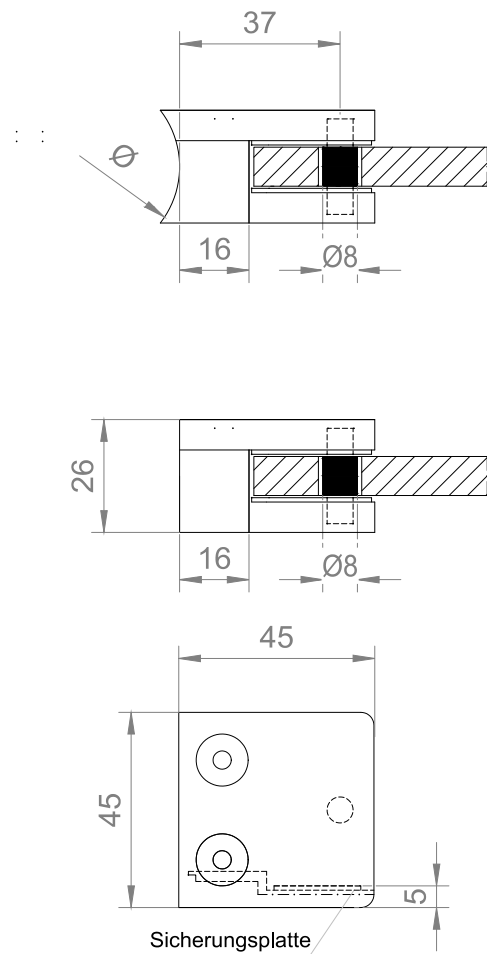

Model 5310  
Model 5300



# GLASS CLAMP SYSTEMS WITH ABP CERTIFICATE

## Glass clamp for 16.76 - 21.52 mm



| For 16.76 - 21.52 mm thick glass, incl. security pin  
| VE: 4 pcs

Modell 5400	AISI 304 (inside)	AISI 316 (outside)
Mounting	Art. no.	Art. no.
flat	12.5400.000.21	12.5400.000.31
Ø 42.4	12.5400.420.21	12.5400.420.31
Ø 48.3	12.5400.480.21	12.5400.480.31

## Glass clamp rubber inlay for 16.76 - 21.52 mm



| For model 5400  
| VE: 12 pcs

Modell 5400	
For glass thickness	Art. no.
8/8/2 (8.76 mm)	90.5400.016.76
8/8/4 (17.52 mm)	90.5400.017.52
10/10/2 (20.76 mm)	90.5400.020.76
10/10/4 (21.52 mm)	90.5400.021.52

## Glass clamp



| For 8-12.76 mm thick glass, incl. security pin  
| Mounting: flat  
| VE: 4 pcs

Modell 5100	
Material	Art. no.
AISI 304	12.5100.000.21
AISI 316	12.5100.000.31

## Glass clamp



| For 8-12.76 mm thick glass, incl. security pin  
| Mounting: 42.4 mm radius  
| VE: 4 pcs

Modell 5100	
Material	Art. no.
AISI 304	12.5100.420.21
AISI 316	12.5100.420.31

# GLASS CLAMP SYSTEMS WITH ABP CERTIFICATE

## Glass clamp



- | For 8-10.76 mm thick glass, incl. security pin and security plate
- | Mounting: flat
- | VE: 4 pcs

Modell 5310	
Material	Art. no.
AISI 304	12.5310.000.21
AISI 316	12.5310.000.31

## Glass clamp



- | For 8-10.76 mm thick glass, incl. security pin and security plate
- | Mounting: 42.4 mm radius
- | VE: 4 pcs

Modell 5310	
Material	Art. no.
AISI 304	12.5310.420.21
AISI 316	12.5310.420.31

## Glass clamp



- | For 8 - 10.76 mm thick glass
- | Mounting: flat
- | VE: 4 pcs

Modell 5300	
Material	Art. no.
AISI 304	12.5300.000.21
AISI 316	12.5300.000.31

## Glass clamp



- | For 8 - 10.76 mm thick glass
- | Mounting: 42.4 mm radius
- | VE: 4 pcs

Modell 5300	
Material	Art. no.
AISI 304	12.5300.420.21
AISI 316	12.5300.420.31

# GLASS CLAMP SYSTEMS WITH ABP CERTIFICATE

## Glass clamp rubber inlay



| For model 5100  
| VE: 12 pcs

Modell 5100	
For glass thickness	Art. no.
8.76 mm	90.5100.008.76
10.76 mm	90.5100.010.76
12.76 mm	90.5100.012.76

## Glass clamp rubber inlay



| For models 5300 and 5310  
| VE: 12 pcs

Modell 5300 & 5310	
For glass thickness	Art. no.
8.76 mm	90.5300.008.76
10.76 mm	90.5300.010.76







# ONLEVEL

**ONLEVEL Ltd.** | Units 6 & 7, Alexandria Court | Alexandria Drive  
Ashton Commerce Park | Ashton-under-Lyne | Lancashire OL7 0QN | United Kingdom  
T +44 0161 804 9500 | F +44 0161 804 9505 | [info@onlevel-uk.com](mailto:info@onlevel-uk.com) | [www.onlevel.com](http://www.onlevel.com)