

ONLEVEL



TL6080 - TL6081
SYSTEMS FOR FRAMELESS
ALL-GLASS BALUSTRADES

TL-6080

0.74 kN Top Mount

Glass profile on diet.

The TL-6080 U Profile is not only cost-effective. It is also an intelligent onward development of the TL-6020 Profile. In addition, it is much slimmer, has increased mounting distances and an extra low profile height of only 125 mm. Therefore, this product is not only less expensive to mount but also offers your customer an unobstructed view from their balcony.

As a matter of fact, the profile is suited both for interior and exterior applications. It can withstand a linear load of more than 0.74 and is appropriate for glass thicknesses between 12 mm and 21.52 mm.

Essential Features

- | Slimline, elegant design and low-maintenance
- | **ONLEVEL** FLEXFIT Glass Adjustment Tool
- | Top Cover (optional)
- | Extra low profile height of only 125 mm
- | For use with 3.0 kN Top Cover
- | For glass thicknesses between 12 - 21.52 mm

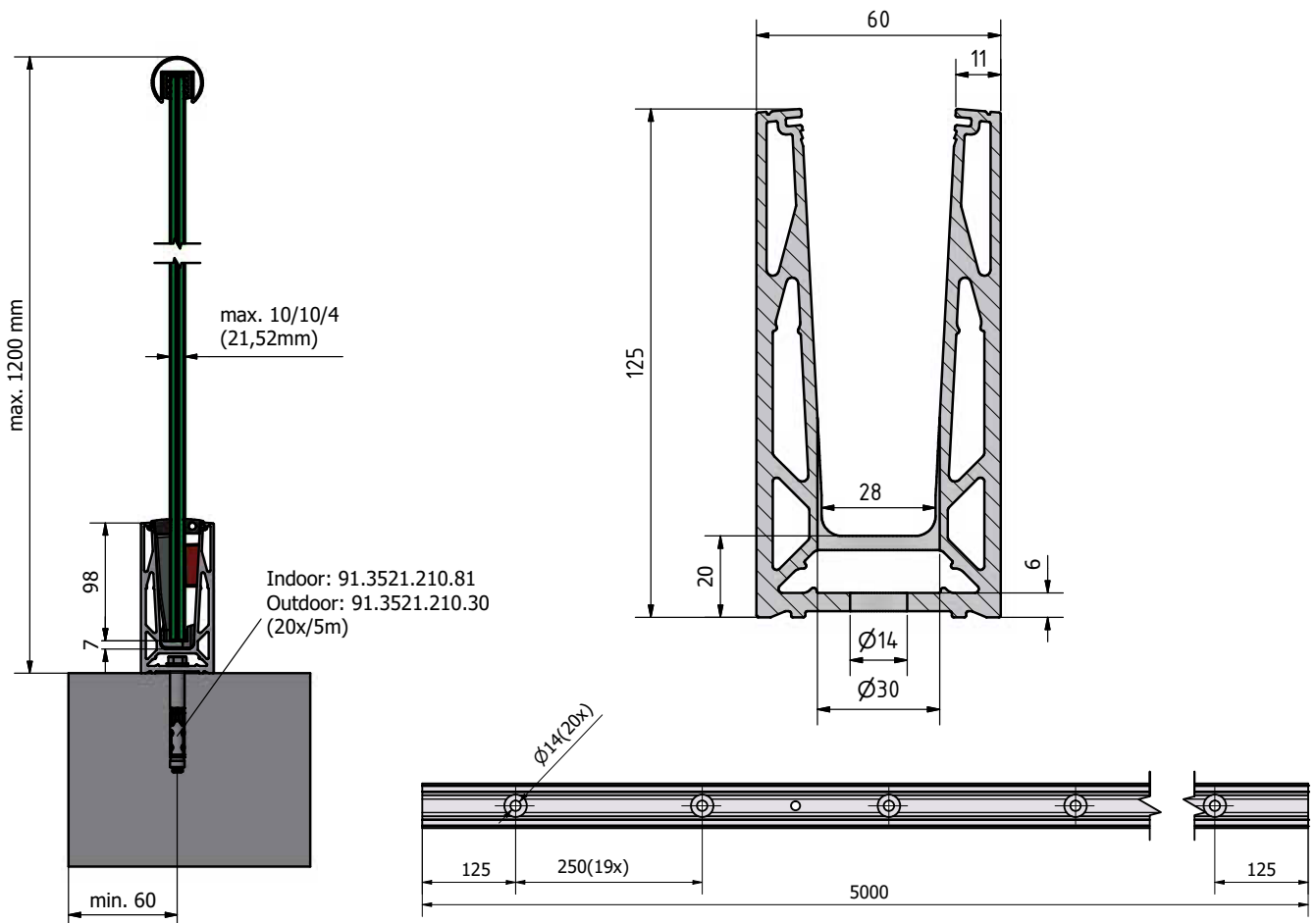



Extra low profile height
of only 125 mm

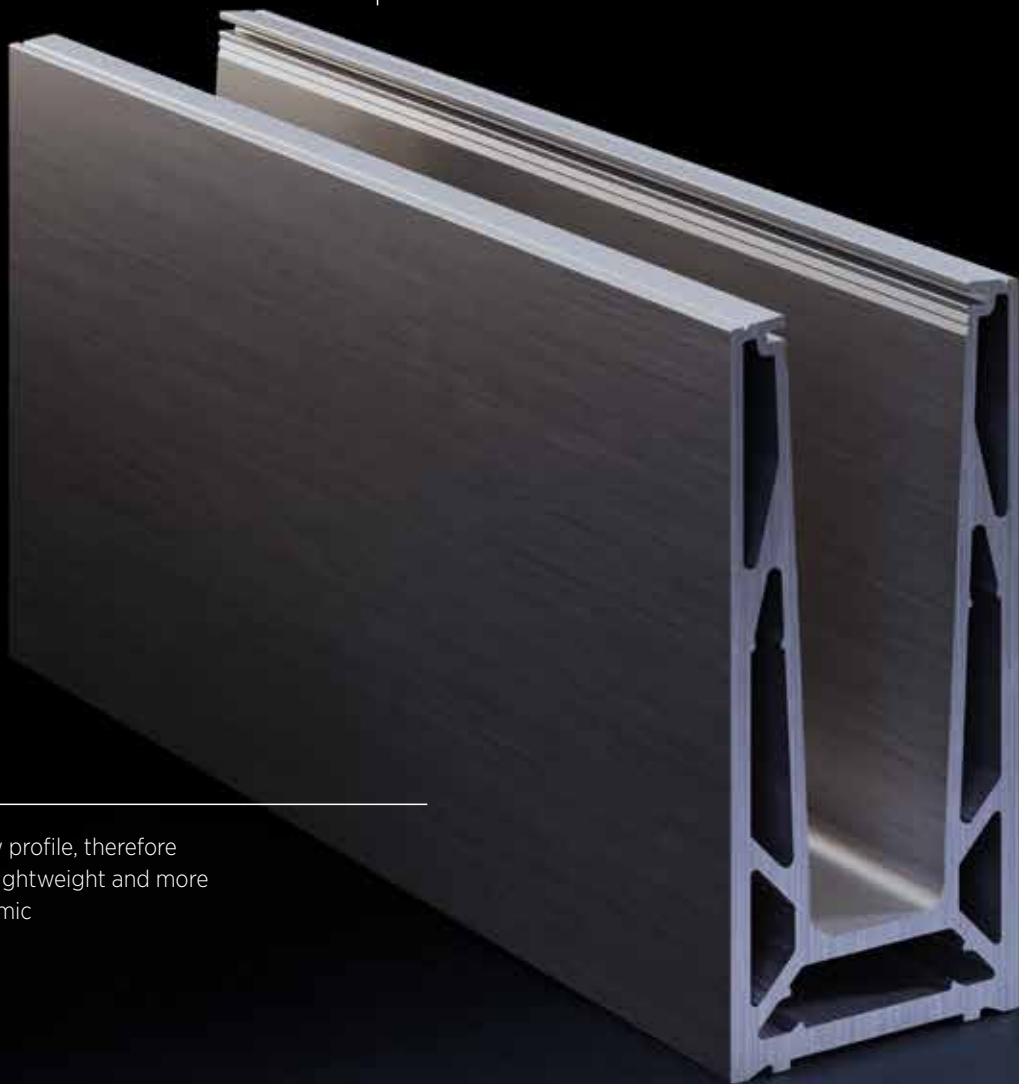

Hollow profile, therefore
more lightweight and more
economic

 Top mount



TL-6080 | 0.74 KN TOP MOUNT

Glass profile



| Height: 125 mm
| Width: 60 mm
| Sales unit: 1 piece

Model 6080	Mill finish	Plain aluminium	RAL coloured	Alum. black anodised
Length	Art. no.	Art. no.	Art. no.	Art. no.
2500	10.6080.002.10	10.6080.002.11	10.6080.002.13/16/18/19	10.6080.002.15
5000	10.6080.005.10	10.6080.005.11	10.6080.005.13/16/18/19	10.6080.005.15

Inside corner / outside corner 90°



| Side length inside: 140 mm
| Side length outside: 200 mm
| Sales unit: 1 piece

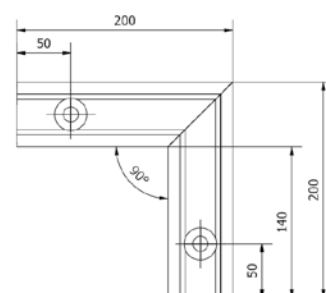

Model 6080	Mill finish	Plain aluminium	RAL coloured	Alum. black anodised
	Art. no.	Art. no.	Art. no.	Art. no.
	10.6080.390.10	10.6080.390.11	10.6080.390.13/16/18/19	10.6080.390.15

End cap, left/right



| For use on the left and right
| Sales unit: 1 piece

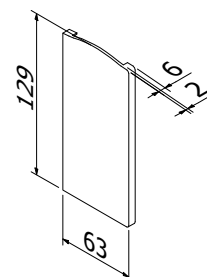

Model 6080	Mill finish	Plain aluminium	RAL coloured	Alum. black anodised
Application	Art. no.	Art. no.	Art. no.	Art. no.
left/right	10.6080.490.10	10.6080.490.11	10.6080.490.13/16/18/19	10.6080.490.15

End cap for staircase, left/right



| For use on the left and right
| Sales unit: 1 piece

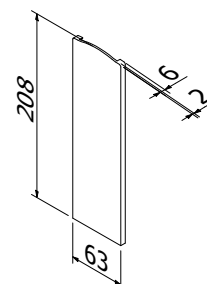

Model 6080	Mill finish	Plain aluminium	RAL coloured
Application	Art. no.	Art. no.	Art. no.
left/right	10.6080.491.10	10.6080.491.11	10.6080.491.13/16/18/19

TL-6080 | 0.74 KN TOP MOUNT

Spacer



You do not have any drainage options on your balcony?!
So that you do not need to install a dam on your balcony,
you can simply mount the spacers beneath your profile.

- | Inner drill hole: Ø 14 mm
- | Sales unit: 13 pieces

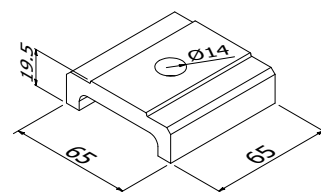

Model 6080	Mill finish	Plain aluminium	RAL coloured
	Art. no.	Art. no.	Art. no.
	10.6080.500.10	10.6080.500.11	10.6020.800.13/16/18/19

Extension pin



- | Length: 40 mm
- | Diameter: Ø 6 mm
- | Sales unit: 8 pieces



Model 7001	AISI 316 (inside & outside)
	Art. no.
	90.7001.640.31



Fischer fixing anchor FH II 12/10



- | Finish interior application: zinc-plated steel (inside)
- | Finish exterior application: V4A (exterior)
- | Required number per 5000mm: 20 pieces
- | Sales unit: 50 pieces

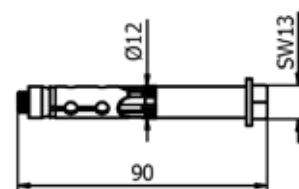

Model 3521	zinc-plated steel (inside)	AISI 316 (exterior)
	Art. no.	Art. no.
	91.3521.210.81	91.3521.210.30

Fischer ixing anchor FIS A M12x120



- | Suitable mortar: 91.3000.010.00
- | V4A (outside)
- | Required number per 5000mm: 20 pieces
- | Sales unit = 10 pieces

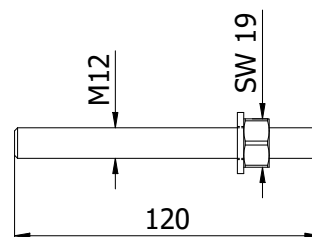

Model 3551	V4A (outside)
	Art. no.
	91.3551.212.30

TL-6080 | 0.74 KN TOP MOUNT

Onlevel fixing anchor SZ-S 12-10



- | Finish interior application: zinc-plated steel (interior)
- | Finish exterior application: V4A (outside)
- | Required number per 5000mm: 20 pieces
- | Sales unit: 50 pieces

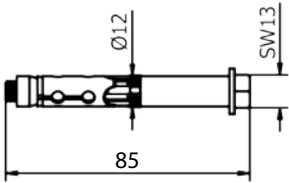

Model 3621	zinc-plated steel (interior)	V4A (outside)
	Art. no.	Art. no.
	91.3621.210.81	91.3621.210.30

Mounting set for steel

- | Finish interior application: zinc-plated steel (inside)
- | Finish exterior application: V4A (exterior)
- | Required number per 5000 mm: 20 pieces
- | M12 x 40 mm
- | Sales unit: 10 piece

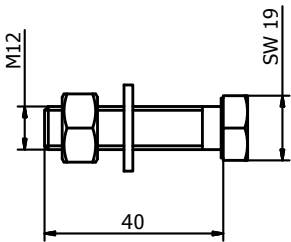

Model 6080	zinc-plated steel (inside)	AISI 316 (exterior)
	Art. no.	Art. no.
	91.6080.040.81	91.6080.040.30

FLEXFIT 1.0 kN

- | Fine adjustment of glass panes
- | For glass thicknesses between 12 - 21.52 mm
- | Adjustment of up to 34 mm in relation to the vertical axis
- | Pay attention to the right glass thickness!



Length		2500 mm	5000 mm	25 mtr
Glass thickness	Wedge colour	Art. no.	Art. no.	Art. no.
12 mm	black	-	90.0505.112.00	-
6/6/4 (13.52 mm)	grey	-	90.0505.114.00	-
8/8/4 (17.52 mm)	green	90.0502.118.00	90.0505.118.00	90.0525.118.00
10/10/4 (21.52 mm)	green	90.0502.122.00	90.0505.122.00	90.0525.122.00



TL-6081

0.74 kN Side Mount

Glass profile with slim hips.

The TL-6081 U Profile is the intelligent onward development of the TL-6021 Profile. It is much slimmer and stands out due to its extra low profile height of only 125 mm. What is so special about it is the fact that the mounting distances have been increased. That makes the product much faster and cheaper to mount.

As a matter of fact, the profile is suited both for interior and exterior applications. It can withstand a linear load of up to 1.0 kN and is appropriate for glass thicknesses between 12 mm and 21.52 mm.

Essential Features

- | Slimline, elegant design and low-maintenance
- | ONLEVEL FLEXFIT Glass Adjustment Tool
- | Drainage holes
- | Cover (optional)
- | For use with 3.0 kN Top Cover
- | Extra low profile height of only 125 mm
- | For glass thicknesses between 12 mm and 21.52 mm

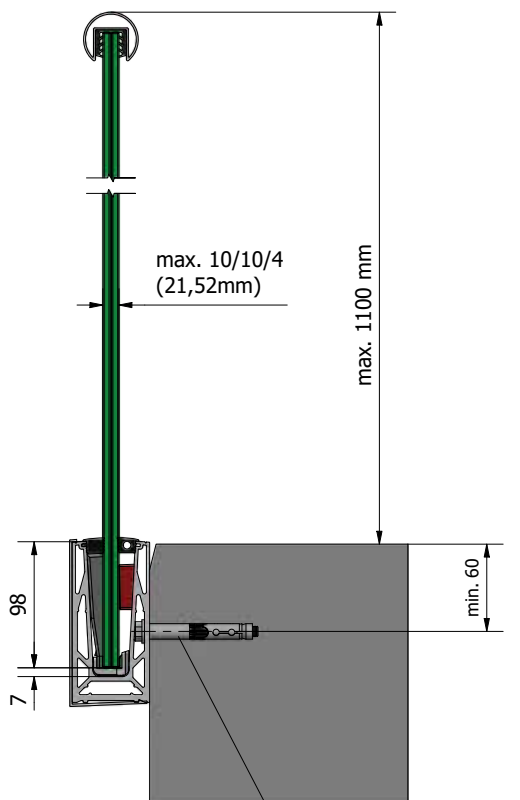

Indoor: 91.3521.210.81
Outdoor: 91.3521.210.30
(20x/5m)

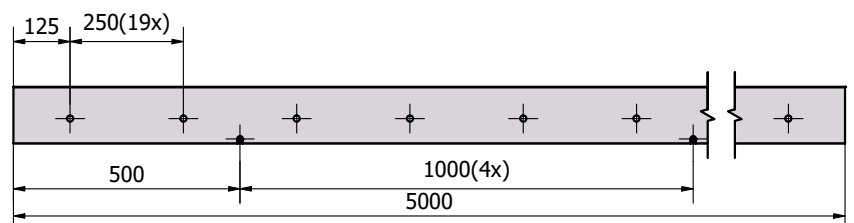
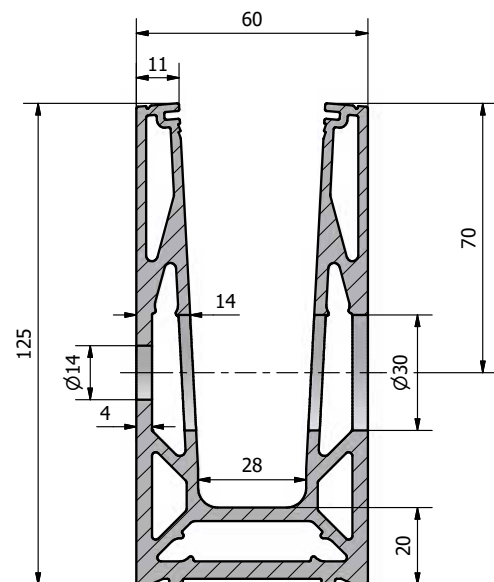



Extra low profile height
of only 125 mm



Side mount

Integrated multifunctional
sophisticated chamber for
enabling larger drilling distances

TL-6081 | 0.74 KN SIDE MOUNT

Glass profile



- | Height: 125 mm
- | Width 60 mm
- | Sales unit: 1 piece

Model 6081	Mill finish	Plain aluminium	RAL coloured	Alum. black anodised
Length	Art. no.	Art. no.	Art. no.	Art. no.
2500	10.6081.002.10	10.6081.002.11	10.6081.002.13/16/18/19	10.6081.002.15
5000	10.6081.005.10	10.6081.005.11	10.6081.005.13/16/18/19	10.6081.005.15

Inside corner 90°



- | Side length inside: 140 mm
- | Side length outside: 200 mm
- | Sales unit: 1 piece

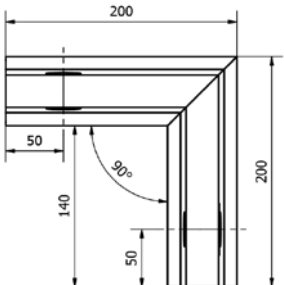

Model 6081	Mill finish	Plain aluminium	RAL coloured	Alum. black anodised
	Art. no.	Art. no.	Art. no.	Art. no.
	10.6081.300.10	10.6081.300.11	10.6081.300.13/16/18/19	10.6081.300.15

Outside corner 90°



- | Side length inside: 140 mm
- | Side length outside: 200 mm
- | Sales unit: 1 piece

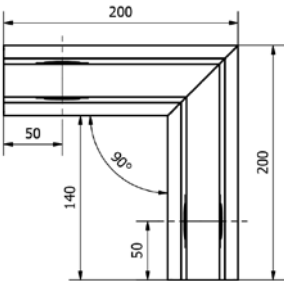

Model 6081	Mill finish	Plain aluminium	RAL coloured	Alum. black anodised
	Art. no.	Art. no.	Art. no.	Art. no.
	10.6081.350.10	10.6081.350.11	10.6081.350.13/16/18/19	10.6081.350.15

Cover Cap



- | With mounting strips
- | Sales unit: 1 piece

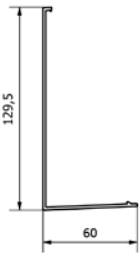

Model 6081	Mill finish	Plain aluminium	RAL coloured	Alum. black anodised
Length	Art. no.	Art. no.	Art. no.	Art. no.
5000	10.6081.205.10	10.6081.205.11	10.6081.205.13/16/18/19	10.6081.205.15

TL-6081 | 0.74 KN SIDE MOUNT

End cap without Cover Cap, left



| For use on the left
| Sales unit: 1 piece

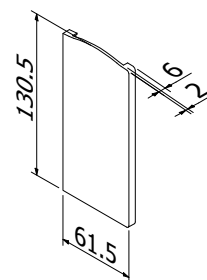

Model 6081	Mill finish	Plain aluminium	RAL coloured	Alum. black anodised
Application	Art. no.	Art. no.	Art. no.	Art. no.
left	10.6081.400.10	10.6081.400.11	10.6081.400.13/16/18/19	10.6081.400.15

End cap without Cover Cap, right



| For use on the right
| Sales unit: 1 piece

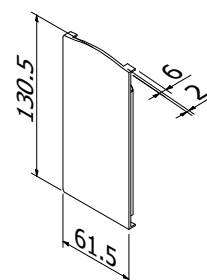

Model 6081	Mill finish	Plain aluminium	RAL coloured	Alum. black anodised
Application	Art. no.	Art. no.	Art. no.	Art. no.
right	10.6081.450.10	10.6081.450.11	10.6081.450.13/16/18/19	10.6081.450.15

End cap with Cover Cap, left



| For use on the left
| Sales unit: 1 piece

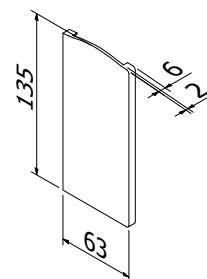

Model 6081	Mill finish	Plain aluminium	RAL coloured	Alum. black anodised
Application	Art. no.	Art. no.	Art. no.	Art. no.
left	10.6081.410.10	10.6081.410.11	10.6081.410.13/16/18/19	10.6081.410.15

End cap with Cover Cap, right



| For use on the right
| Sales unit: 1 piece

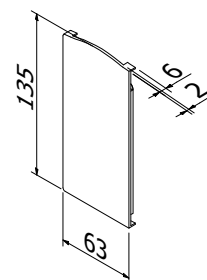

Model 6081	Mill finish	Plain aluminium	RAL coloured	Alum. black anodised
Application	Art. no.	Art. no.	Art. no.	Art. no.
right	10.6081.460.10	10.6081.460.11	10.6081.460.13/16/18/19	10.6081.460.15

TL-6081 | 0.74 KN SIDE MOUNT

End cap for staircase with cover strip, left



| For use on the left
| can be cut to size
| Sales unit: 1 piece

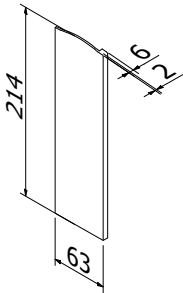

Model 6081	Mill finish	Plain aluminium	RAL coloured
Application	Art. no.	Art. no.	Art. no.
right	10.6081.411.10	10.6081.411.11	10.6081.411.13/16/18/19

End cap for staircase with cover strip, right



| For use on the right
| can be cut to size
| Sales unit: 1 piece

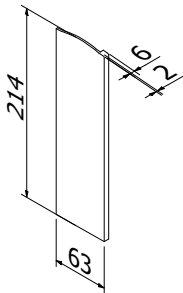

Model 6081	Mill finish	Plain aluminium	RAL coloured
Application	Art. no.	Art. no.	Art. no.
right	10.6081.461.10	10.6081.461.11	10.6081.461.13/16/18/19

Spacer



| Thickness: 15 mm
| Sales unit: 13 pieces

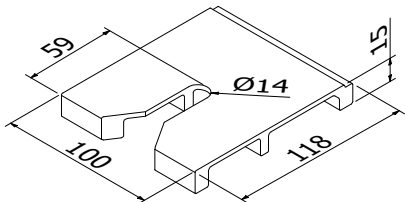

Model 6081	Mill finish	Plain aluminium	RAL coloured
	Art. no.	Art. no.	Art. no.
	10.6081.500.10	10.6081.500.11	10.6081.500.13/16/18/19

Blanking plug



| Required number per 5000 mm: 20 pieces
| Sales unit: 10 pieces

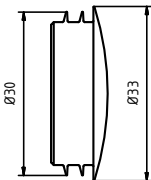

Model 7000	Plastic	
Colour	Diameter	Art. no.
white	30 mm	90.7000.030.40
black	30 mm	90.7000.030.41
grey	30 mm	90.7000.030.45

TL-6081 | 0.74 KN SIDE MOUNT

Extension pin



| Length: 40 mm
| Diameter: Ø 6 mm
| Sales unit: 8 pieces

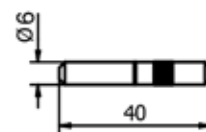

Model 7001	AISI 316 (inside & outside)
Art. no.	
90.7001.640.31	

Fischer fixing anchor FH II 12/10



| Finish interior application: zinc-plated steel (inside)
| Finish exterior application: V4A (exterior)
| Required number per 5000mm: 20 pieces
| Sales unit: 50 pieces

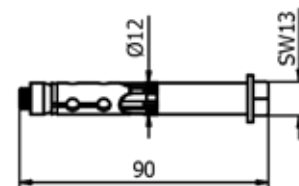

Model 3521	zinc-plated steel (inside)	AISI 316 (exterior)
Art. no.		Art. no.
91.3521.210.81		91.3521.210.30

Onlevel fixing anchor SZ-S 12-10



| Finish interior application: zinc-plated steel (interior)
| Finish exterior application: V4A (outside)
| Required number per 5000mm: 20 pieces
| Sales unit: 50 pieces

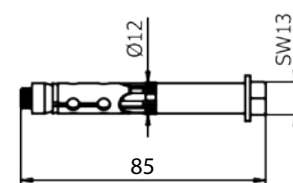

Model 3621	zinc-plated steel (interior)	V4A (outside)
Art. no.		Art. no.
91.3621.210.81		91.3621.210.30

Mounting set for steel



| Finish interior application: zinc-plated steel (inside)
| Finish exterior application: V4A (exterior)
| Required number per 5000 mm: 20 pieces
| M12 x 40 mm
| Sales unit: 10 piece

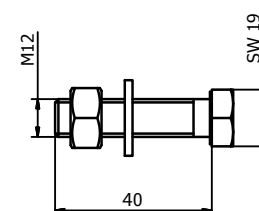

Model 6081	zinc-plated steel (inside)	AISI 316 (exterior)
Art. no.		Art. no.
91.6081.040.81		91.6081.040.30

TL-6081 | 1.0 KN SIDE MOUNT

FLEXFIT 1.0 kN



- | Fine adjustment of glass panes
- | For glass thicknesses between 12 - 21.52 mm
- | Adjustment of up to 34 mm in relation to the vertical axis
- | Pay attention to the right glass thickness!

Length		2500 mm	5000 mm	25 mtr
Glass thickness	Wedge colour	Art. no.	Art. no.	Art. no.
12 mm	black	-	90.0505.112.00	-
6/6/4 (13.52 mm)	grey	-	90.0505.114.00	-
8/8/4 (17.52 mm)	green	90.0502.118.00	90.0505.118.00	90.0525.118.00
10/10/4 (21.52 mm)	green	90.0502.122.00	90.0505.122.00	90.0525.122.00





ONLEVEL

ONLEVEL Ltd. | Unit 7, Alexandria Court | Alexandria Drive
Ashton Commerce Park | Ashton-under-Lyne | Lancashire OL7 0QN | United Kingdom
T +44 0161 804 9500 | F +44 0161 804 9505 | info@onlevel-uk.com | www.onlevel.com