



ONLEVEL

*LAZOR***TRACK**  
MOUNTING INSTRUCTIONS

### About these instructions

This instruction manual is part of the product and contains information about the scope of delivery as well as proper installation and adjustment of the product.

Make sure to read the complete manual before performing any work to guarantee a safe installation and use of the product. The information contained herein will maximize your safety.

Keep the manual in a safe place to have it at hand at all times.

We reserve any technical changes required to improve this product which diverge from the presentation given in this manual. The illustrations of this manual serve the basic understanding and may vary from the actual design.

### Intended use

Our LAZORTRACK product is illuminating handrail system that can be installed on glass and wall.

Use our product exclusively as described in this manual. Any other application is considered contrary to the intended use.

### Misuse

All of the following are considered foreseeable misuse:

- | Bending LED strips in the wrong direction.
- | Incorrectly cutting LED strips.
- | Using excessive force when setting up and disassembling LED strips.
- | Wrongly joining components.
- | Not taking into account the distance between handrails, which ruins the strip as the handrail expands and shrinks as a consequence of heat.

### Liability

The system may only be put together with original parts.

We do not accept liability for any damage resulting from a not intended use or the use of parts without approval.

### Staff

Our product must only be mounted by qualified staff who have the appropriate training and experience to carry out such works. The staff must be able to identify risks while handling the product and avoid any potential dangers.

The installation must be carried out by at least two people.

### Safety



This is a danger sign. It alerts you of risks of injury. Therefore, please take all measures indicated together with this symbol to avoid injuries.

Safety at work comes first – always wear your personal protective equipment.

- | Safety shoes
- | Work clothes
- | Protective gloves

### Storage

Store the supplied parts in their original packaging to avoid damage to the product.

Consider the following to avoid damage to the glass elements:

- | Always store and transport glass elements in an upright position and without bending.
- | Store glass elements in a safe place and protect them from tipping over.
- | Do not place glass elements on hard or uneven surfaces.



It's optional to use Controller 18.3005.010.00. The system needs to be installed indoors to be used.

Note: One remote control (18.3004.000.00 or 18.3004.010.00) can control upto ten LED strips.

## Info for Single-Colour LED strip:

Colour temperature:	4000K
Input Voltage:	24VDC
Power consumption:	7W/meter
Protection level:	IP67
Dimensions:	6x12mm
Dimmable:	Yes
Cutting line:	Every 4.17cm
Number of LEDs:	144/meter

## Info for RGB LED strip:

Colour temperature:	2835 RGB
Input Voltage:	24VDC
Power consumption:	7W/meter
Protection level:	IP67
Dimensions:	6x12mm
Dimmable:	Yes
Cutting line:	Every 5cm
Number of LEDs:	120/meter

## 4000K LED

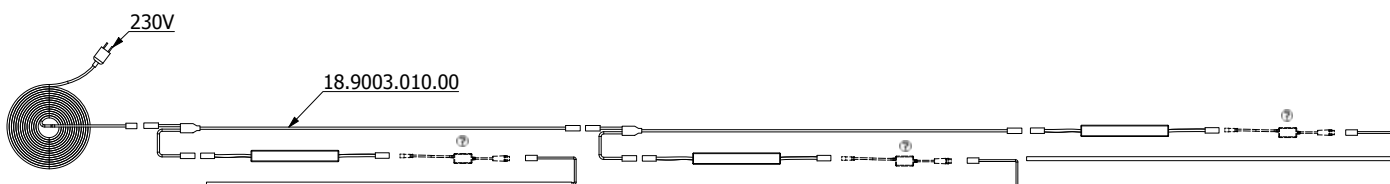
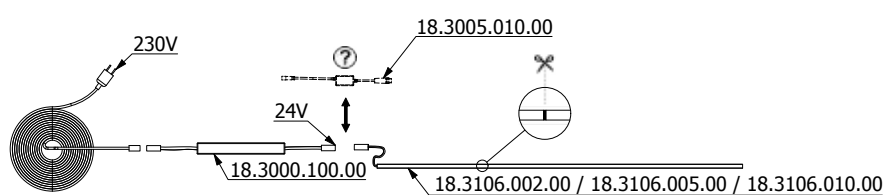

## RGB LED

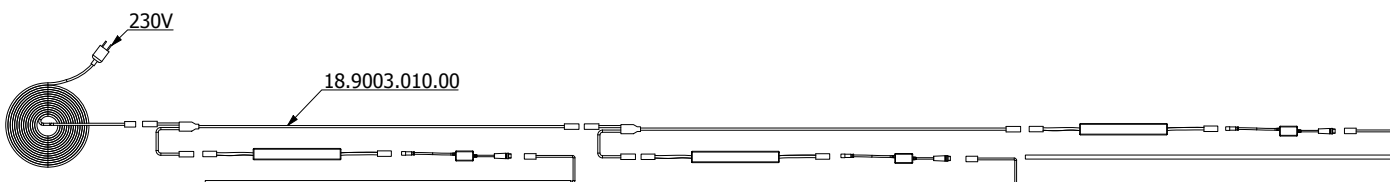
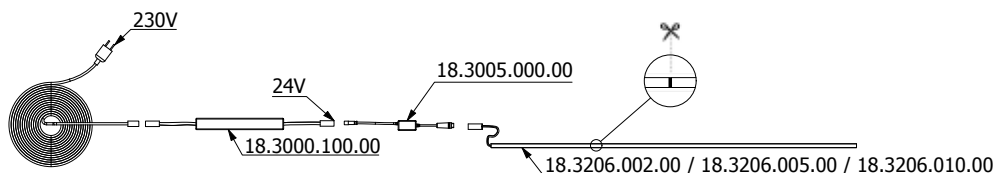

# LAZOR**TRACK** | FLOOR CONNECTION

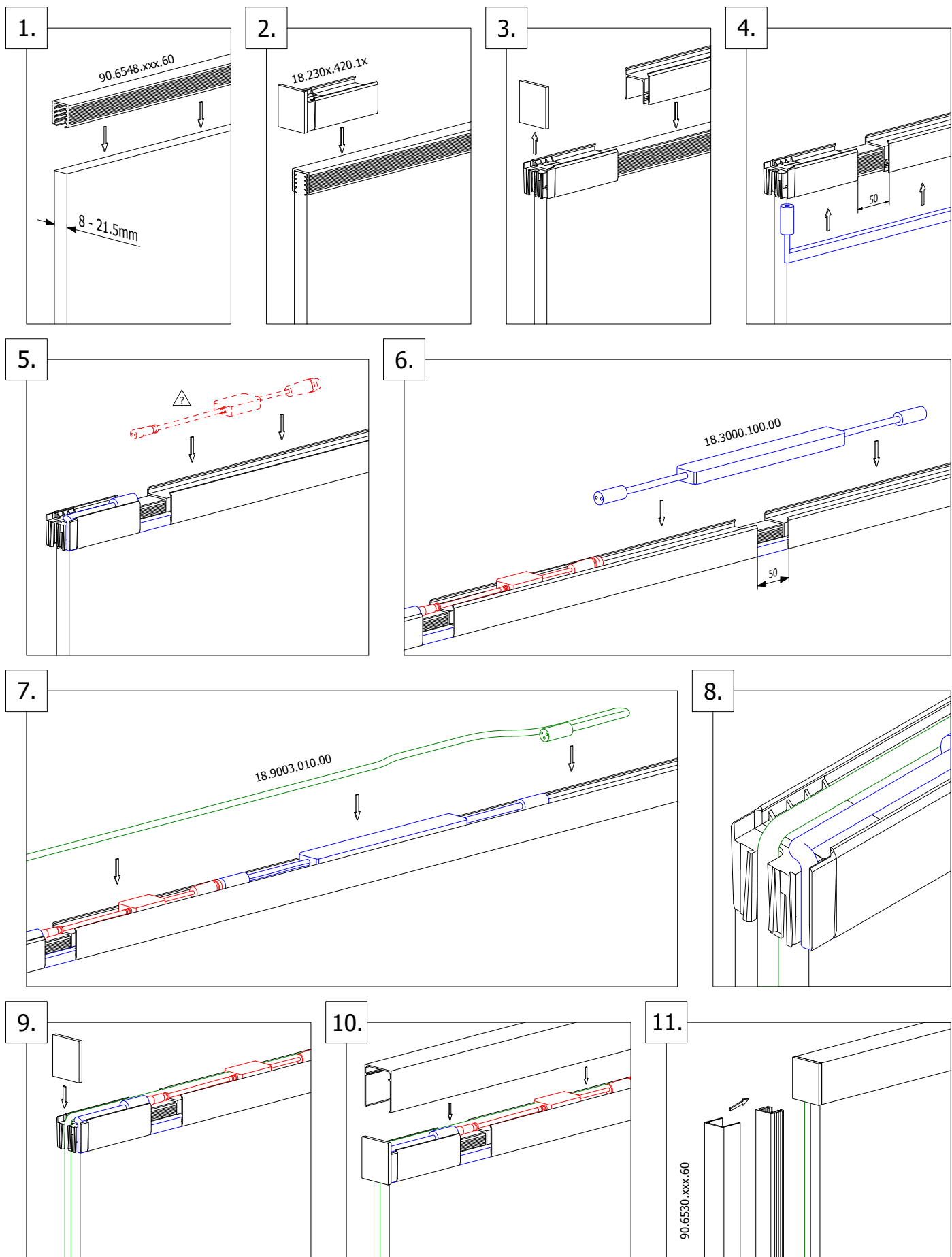

# LAZOR**TRACK** | WALL CONNECTION

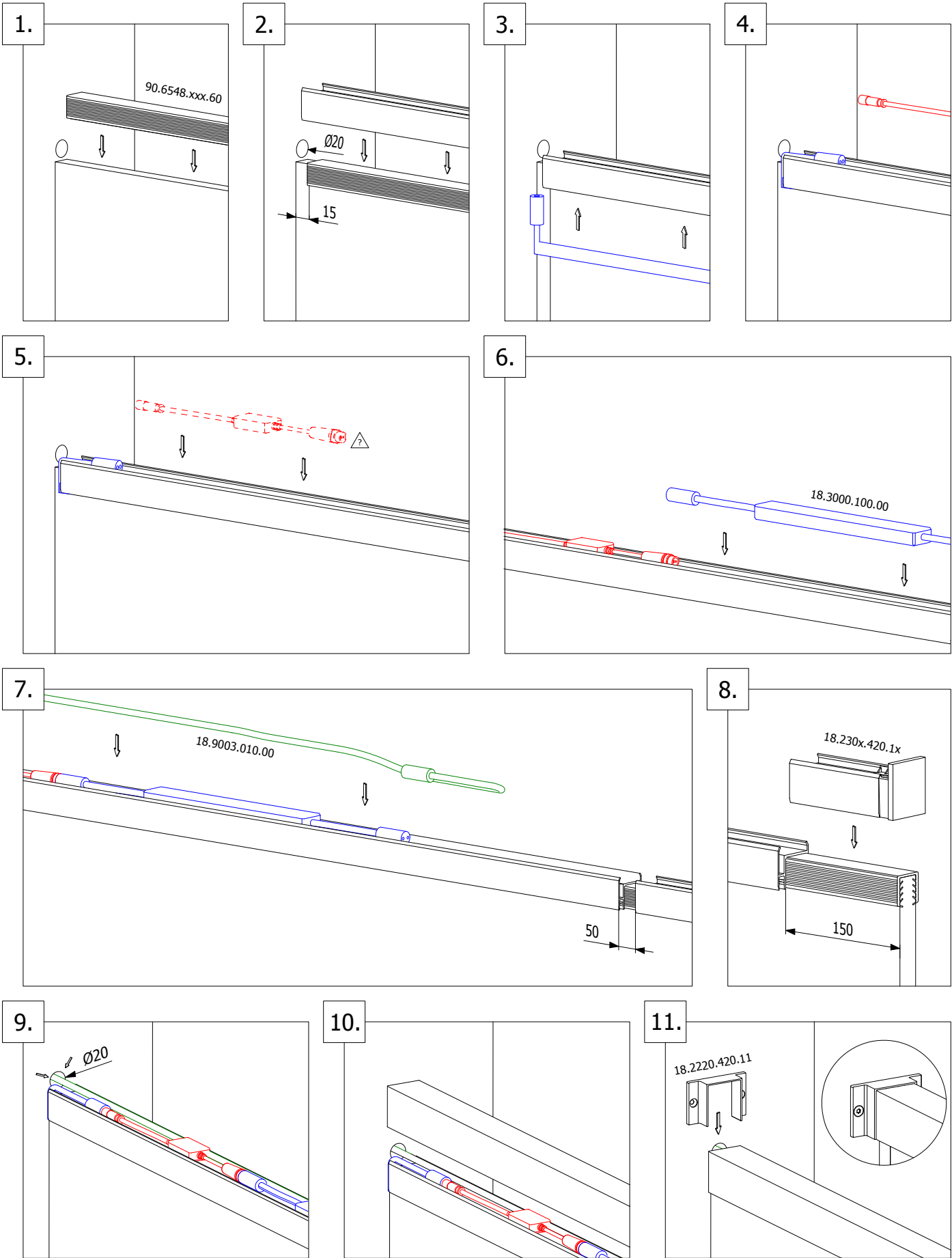



# ONLEVEL

**ONLEVEL GmbH** | Budberger Straße 5 | 46446 Emmerich am Rhein | Germany  
+49 (0)2822 97514-0 | [info@onlevel.com](mailto:info@onlevel.com) | [www.onlevel.com](http://www.onlevel.com)