

ONLEVEL



CANTILEVER GLASS CANOPY
INDIVIDUAL PARTS FOR SELF-ASSEMBLY

AIRFORCE | INDIVIDUAL PARTS

AIRFORCE glass profile



| Length: 5000 mm
| Sales unit: 1 piece

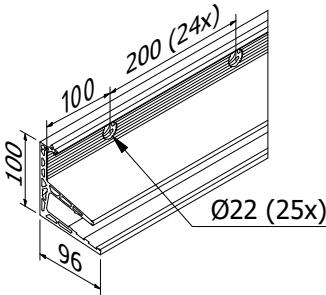

Model 9010	Mill finish	Natural anodised
Length	Art. no.	Art. no.
5000	17.9010.005.10	17.9010.005.11

AIRFORCE Cover Cap Profile



| Length: 5000 mm
| Sales unit: 1 piece

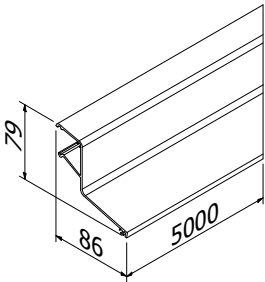

Model 9011	Mill finish	Natural anodised
Length	Art. no.	Art. no.
5000	17.9011.005.10	17.9011.005.11

AIRFORCE plastic profile backside 10/10/4 (21.52 mm)



| for glass thickness 10/10/4 (21.52 mm)
| Length: 5000 mm
| Sales unit: 1 piece

| Also required for Glasstärke 8/8/4 (17.52 mm)

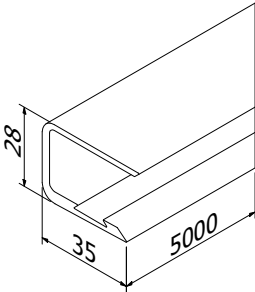

Model 9012	Plastic black
	Art. no.
	17.9012.005.41

AIRFORCE plastic profile backside 8/8/4 (17.52 mm)



| for glass thickness 8/8/4 (17.52 mm)
| Length: 5000 mm
| Sales unit: 1 piece

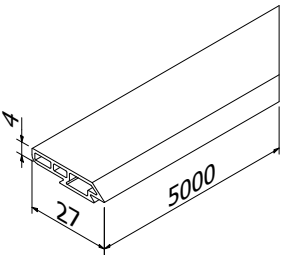

Model 9013	Plastic black
	Art. no.
	17.9013.005.41

AIRFORCE | INDIVIDUAL PARTS

AIRFORCE plastic profile frontside 10/10/4 (21.52 mm)



- | for glass thickness 10/10/4 (21.52 mm)
- | Length: 5000 mm
- | Sales unit: 1 piece
- | Also required for Glasstärke 8/8/4 (17.52 mm)

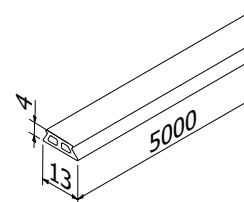

Model 9014	Plastic black
Art. no.	
17.9014.005.41	

AIRFORCE plastic profile frontside 8/8/4 (17.52 mm)



- | for glass thickness 8/8/4 (17.52 mm)
- | Length: 5000 mm
- | Sales unit: 1 piece

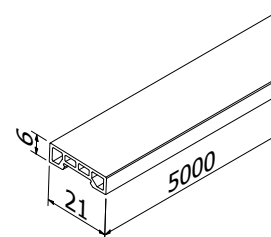

Model 9015	Plastic black
Art. no.	
17.9015.005.41	

AIRFORCE Cover Cap Clip



- | Sales unit: 1 piece

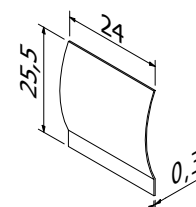

Model 9016	AISI 304 (interior)
Art. no.	
17.9016.000.20	

AIRFORCE Mounting Block Ø12mm

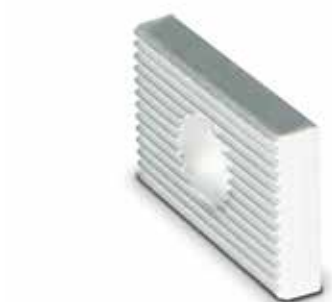

- | Sales unit: 1 piece

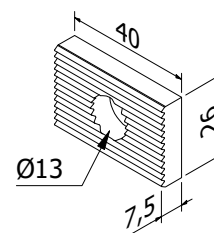

Model 9017	Natural anodised
Art. no.	
17.9017.012.11	

AIRFORCE | INDIVIDUAL PARTS

AIRFORCE Glass Rubber



| Length: 2500 mm
| Sales unit: 1 Piece

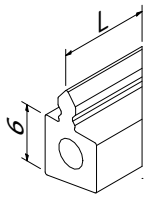

Model 9018	Plastic
Length	Art. no.
2500	17.9018.025.60

AIRFORCE Fixation Block 10/10/4 (21.52 mm)



| for glass thickness 10/10/4 (21.52 mm)
| Sales unit: 2 Piece

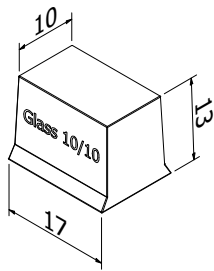

Model 9019	Plastic
	Art. no.
	17.9019.020.41

AIRFORCE fixation block 8/8/4 (17.52mm)



| for glass thickness 8/8/4 (17.52 mm)
| Sales unit: 2 Piece

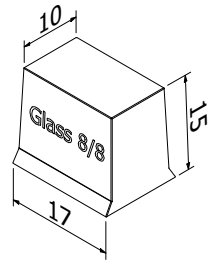

Model 9019	Plastic
	Art. no.
	17.9019.016.41

AIRFORCE Endcap left



| Can be used on the left
| Sales unit: 1 Piece

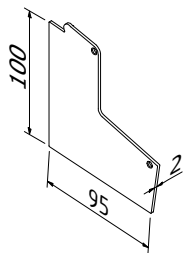

Model 9020	Mill finish	Natural anodised
	Art. no.	Art. no.
	17.9020.000.10	17.9020.000.11

AIRFORCE | INDIVIDUAL PARTS

AIRFORCE Endcap right



- | Can be used on the right
- | Sales unit: 1 Piece

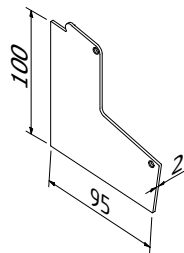

Model 9020	Mill finish	Natural anodised
	Art. no.	Art. no.
	17.9020.010.10	17.9020.010.11

Fischer fixing anchor FAZ II 12/20



- | Finish exterior application: V4A (exterior)
- | Required number per 2500 mm: 7 pieces
- | Sales unit: 20 pieces

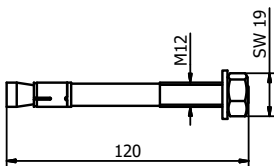

Modell 3501	AISI 316 (exterior)
	Art. no.
	91.3501.220.30

Mounting set on concrete with insulation M12x400mm



- | Sales unit: 8 Piece

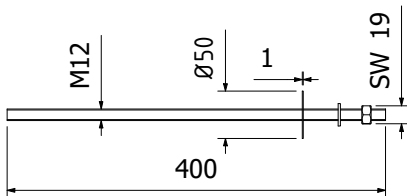

Model 9005	AISI 316 (exterior)	AISI 304 (interior)
	Art. no.	Art. no.
	17.9005.012.30	17.9005.012.20

Pressure-resistant insulation



- | Length 600 oder 1200 mm
- | Sales unit: 1 Piece

	600 mm	1200 mm
Thickness (t)	Art. no.	Art. no.
10mm	17.9006.016.00	17.9006.010.00
100 mm	17.9006.106.00	17.9006.100.00
150 mm	17.9006.156.00	17.9006.150.00
200 mm	17.9006.206.00	17.9006.200.00

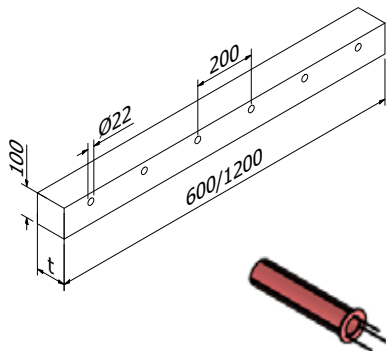

including signal pin for flush-mounted installation (l/hole)

AIRFORCE | INDIVIDUAL PARTS

Mounting set on wood M12x200mm



| Sales unit: 8 Piece

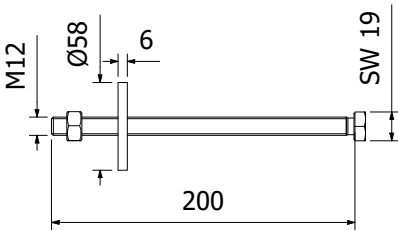

Model 9004	AISI 316 (exterior)	AISI 304 (interior)
	Art. no.	Art. no.
	17.9004.012.30	17.9004.012.20

Mounting set on steel M12x50mm



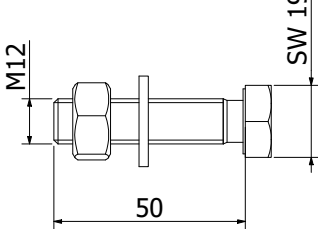

| one anchor is required per 400mm
| Sales unit: 4 pieces



Model 9003	AISI 316 (exterior)	AISI 304 (interior)
	Art. no.	Art. no.
	17.9003.012.30	17.9003.012.20

Extension pin





| Infinite extensions?
No problem, we remove the end cap for you
| Length: 40 mm
| Diameter Ø 6 mm
| Sales unit: 8 pieces

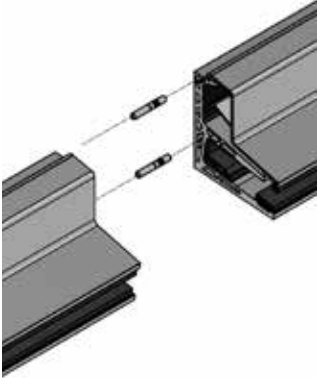

Model 7001	AISI 316 (exterior & interior)
	Art. no.
	90.7001.640.31

Screw for mounting the end cap



| Countersunk head screw with Torx ISO 14587 Ø3.9x16mm, V2A
| is required if the length of the profile is shortened
| Sales unit: 1 piece

Model 1240	V2A (Exterior)
	Art. no.
	91.1240.416.20

AIRFORCE | INDIVIDUAL PARTS

Mortar FIS SB 390 S



- | For chemical anchor bonding
- | Including 2 mixers
- | Sales unit: 1 piece

Model 3000	
	Art. no.
	91.3000.010.00

Dispensing device



- | For use with mortar (91.3000.010.00)
- | Sales unit: 1 piece

Model 3002	Plastic
	Art. no.
Gun	91.3002.010.00
Mixer	91.3002.011.00

Airpump



- | For blowing out the drill holes
- | Sales unit: 1 piece

Model 3001	Plastic
	Art. no.
	91.3001.010.00

Anchor hole brush



- | For cleaning the drill holes
- | Ø 12 mm
- | Sales unit: 1 piece

Model 3002	Plastic
	Art. no.
	91.3002.012.00



ONLEVEL

ONLEVEL Ltd. | Unit 7, Alexandria Court | Alexandria Drive
Ashton Commerce Park | Ashton-under-Lyne | Lancashire OL7 0QN | United Kingdom
T +44 0161 804 9500 | F +44 0161 804 9505 | info@onlevel-uk.com | www.onlevel.com