

## TITAN

Spigots



### TITAN - Glass Spigot Base Fix



- | Spigots are cast in marine grade 316 Grade Stainless Steel
- ideal for pool side or coastal environments
- | Glass thickness 10-21.52mm
- | Sleek Oval Design
- | Cover plate option
- | Tested for 0.74kN loading dependent on the glass thickness.
- | Can be powder coated to RAL
- | Height: 147mm
- | Sales Unit: 1 piece

#### TITAN - Glass Spigot Base Fix

Art.-no. 12.2460.147.38

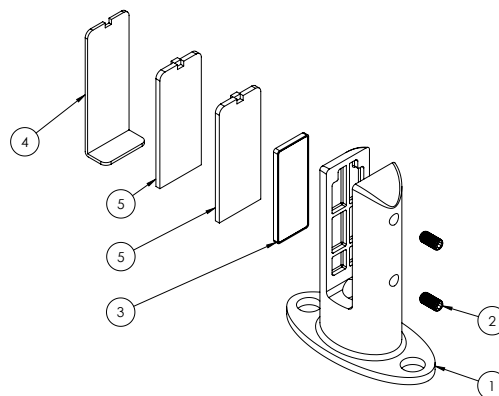
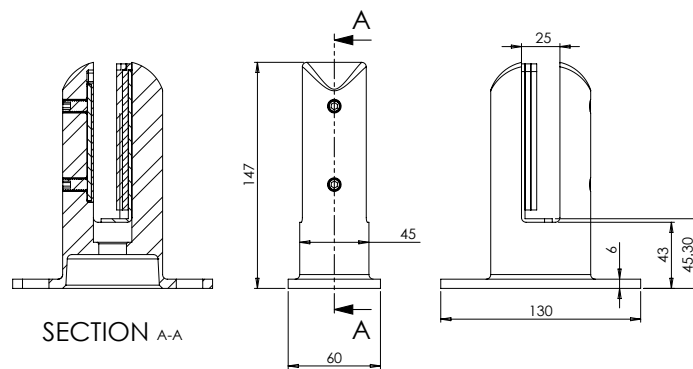

- |   |                                    |
|---|------------------------------------|
| 1 | Glass Spigot Base Fix 10 - 21.52mm |
| 2 | M10 Hex Head                       |
| 3 | Insert - Steel & Plastic           |
| 4 | Insert - L Shaped Plastic          |
| 5 | Insert - Plastic Spacer            |