

ONLEVEL



TL60**50** - TL60**51**
SYSTEMS FOR FRAMELESS
ALL-GLASS BALUSTRADES

TL-6050

1.0 kN Top Mount

Always ON AIR, ON FIRE, ON TOP!

Once again, our Innovation Hotbed has taken up different requirements from construction projects, resulting in the onward development of the TL-6020/6021 profiles and finally a very advanced solution. Always “On Air” when it comes to wind loads, always “On Fire” when improving and simplifying processes – these were the basic conditions for developing the new intermediate size of the ON**LEVEL** TL-6050/6051 profiles.

The TL-6050 U profile can be used for exterior applications. It can withstand a linear load of 1.5 kN and is appropriate for glass thicknesses between 21.52 mm and 31.52 mm.

Essential Features

- | Slimline, elegant design and low-maintenance
- | ON**LEVEL** FLEXFIT Glass Adjustment Tool
- | Extension pin holes
- | Drainage holes
- | For use with Top Cover with 2.0 kN
- | For glass thicknesses between 21.52 - 31.52 mm
- | Mounting distance of 25 cm
- | Profile can withstand higher wind loads



TESTED
according to
BS6180

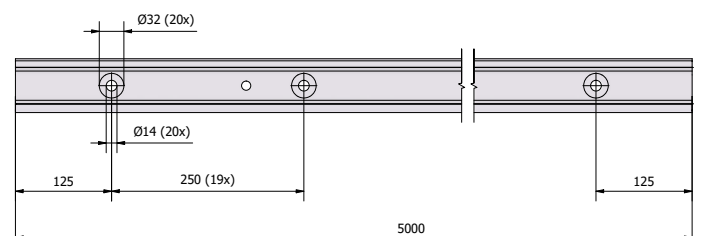
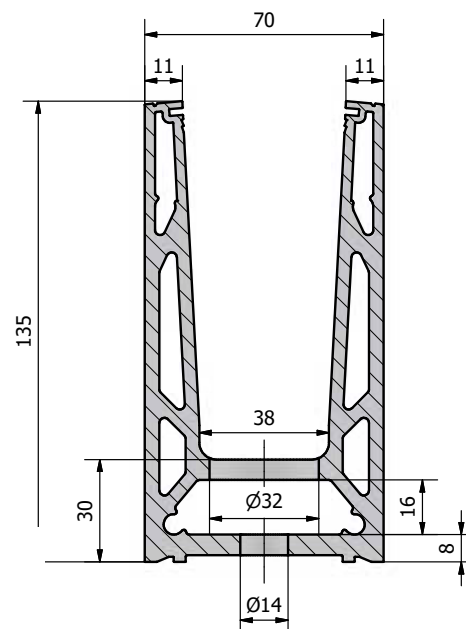
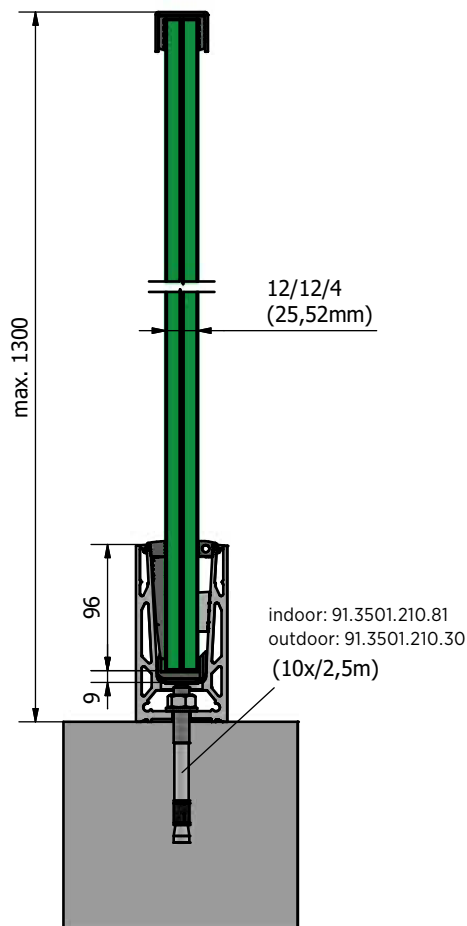



Top mount

TL-6050 | 1.0 KN TOP MOUNT

Glass profile



| Height: 135 mm
| Width: 70 mm
| Sales unit: 1 piece

Model 6050	Mill finish	Plain aluminium	RAL coloured
Length	Art. no.	Art. no.	Art. no.
5000	10.6050.005.10	10.6050.005.11	10.6050.005.13/16/18/19

Inside corner / outside corner 90°



| Side length inside: 130 mm
| Side length outside: 200 mm
| Sales unit: 1 piece

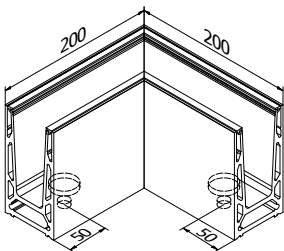

Model 6050	Mill finish	Plain aluminium	RAL coloured
	Art. no.	Art. no.	Art. no.
	10.6050.390.10	10.6050.390.11	10.6050.390.13/16/18/19

End cap, left/right



| For use on the left and right
| Sales unit: 1 piece

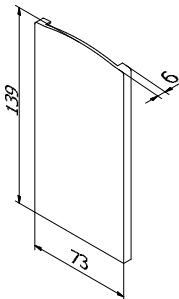

Model 6050	Mill finish	Plain aluminium	RAL coloured
Application	Art. no.	Art. no.	Art. no.
left/right	10.6050.490.10	10.6050.490.11	10.6050.490.13/16/18/19

End cap for staircase, left/right



| For use on the left and right
| cut-to-size
| Sales unit: 1 piece

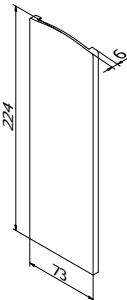

Model 6020	Mill finish	Plain aluminium	RAL coloured
Application	Art. no.	Art. no.	Art. no.
left/right	10.6020.491.10	10.6020.491.11	10.6020.491.13/16/18/19

TL-6050 | 1.0 KN TOP MOUNT

Spacer



You do not have any drainage options on your balcony?!
So that you do not need to install a dam on your balcony, you can simply mount the spacers beneath your profile.

- | Inner drill hole: Ø 14 mm
- | Sales unit: 13 pieces

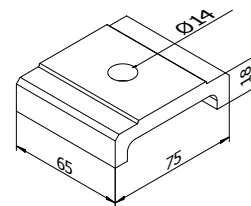

Model 6050	Mill finish	Plain aluminium	RAL coloured
	Art. no.	Art. no.	Art. no.
	10.6050.500.10	10.6050.500.11	10.6050.500.13/16/18/19

Extension pin



- | Length: 40 mm
- | Diameter: Ø 6 mm
- | Sales unit: 8 piece

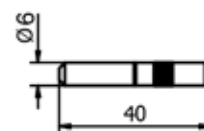

Model 7001	AISI 316 (inside & outside)
	Art. no.
	90.7001.640.31

Fischer fixing anchor FIS AM M10x150



- | Finish interior application: zinc-plated steel (inside)
- | Finish exterior application: V4A (exterior)
- | Required number per 2500 mm: 10 pieces
- | Suitable mortar: 91.3000.010.00
- | Injection mortar (91.3000.010.00) is sufficient for ± 26 anchors
- | Sales unit: 10 pieces

fischer 

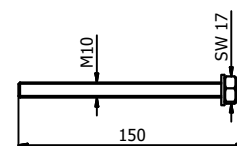

Model 3551	zinc-plated steel (inside)	AISI 316 (exterior)
	Art. no.	Art. no.
	91.3551.015.81	91.3551.015.30

Fixing anchor steel



- | Finish interior application: zinc-plated steel (inside)
- | Finish exterior application: V4A (exterior)
- | Required number per 2500 mm: 10 pieces
- | M12 x 50 mm
- | Sales unit: 10 pieces

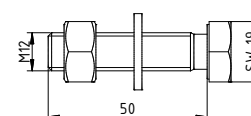

Model 6050	zinc-plated steel (inside)	AISI 316 (exterior)
	Art. no.	Art. no.
	91.6050.050.81	91.6050.050.30

TL-6050 | 1.0 KN TOP MOUNT

Fischer fixing anchor FAZ II 12/10



- | Finish interior application: zinc-plated steel (inside)
- | Finish exterior application: V4A (exterior)
- | Required number per 2500 mm: 10 pieces
- | Sales unit: 20 pieces

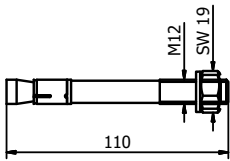

Model 3501	zinc-plated steel (inside)	AISI 316 (exterior)
	Art. no.	Art. no.
	91.3501.210.81	91.3501.210.30

Screw anchor for concrete



- | Suitable for our profiles without countersinking
- | Finish interior application: Zinc-plated steel (interior) HUS3-H 10x90
- | Finish exterior application: V4A (outside) HUS3-HR 10x95
- | Tangential screwdriver required

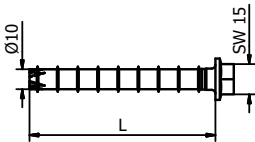

Model 3701	zinc-plated steel (inside)	Model 3701	AISI 316 (exterior)
Sales unit	Art. no.	Sales unit	Art. no.
50	91.3701.090.81	25	91.3701.095.30

FLEXFIT 2.0 kN



- | Fine adjustment of glass panes
- | For glass thicknesses between 21.52 - 31.52 mm
- | Adjustment of up to 34 mm in relation to the vertical axis
- | Attention: Make sure to use the right glass thickness!

Length		5000 mm
Glass thickness	Wedge colour	Art. no.
10/10/4 (21.52 mm)	blue	90.0505.322.00
12/12/4 (25.52 mm)	red	90.0505.326.00
15/15/4 (31.52 mm)	green	90.0505.332.00

TAKE A LITTLE DISTANCE – WITH OUR SPACER.

Hoover Dam is a thing of the past. There is more water on balconies than in the legendary dammed Colorado River. We have the suitable spacer for every profile to keep your feet dry. In addition, our spacers are constructed such as to adapt themselves to all static conditions.

10.6050.500.10



TL-6051

1.0 kN Side Mount

The Evolution Goes On.

The TL-6051 U-profile is the intelligent onward development of the TL-6011 profile. Here the outstanding feature consists in the increase of mounting distances, which now enables the use of the profile also on an anchor bolt without countersunk head. This makes mounting the product not only much quicker and more cost efficient, also statics have improved significantly.

The TL-6051 U-profile can be used for exterior applications. It can withstand a linear load of 1.0 kN and is appropriate for glass thicknesses between 12 mm and 21.52 mm.

Essential Features

- | Slimline, elegant design and low-maintenance
- | **ONLEVEL** FLEXFIT Glass Adjustment Tool
- | Drainage holes
- | Cover (optional)
- | For use with Top Cover with 2.0 kN
- | For glass thicknesses between 21.52 mm and 31.52 mm



TESTED
according to
BS6180

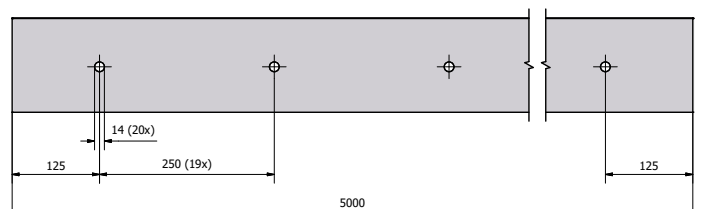
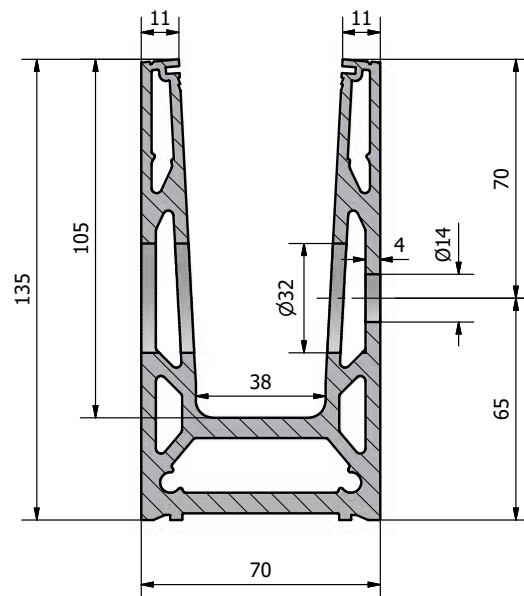
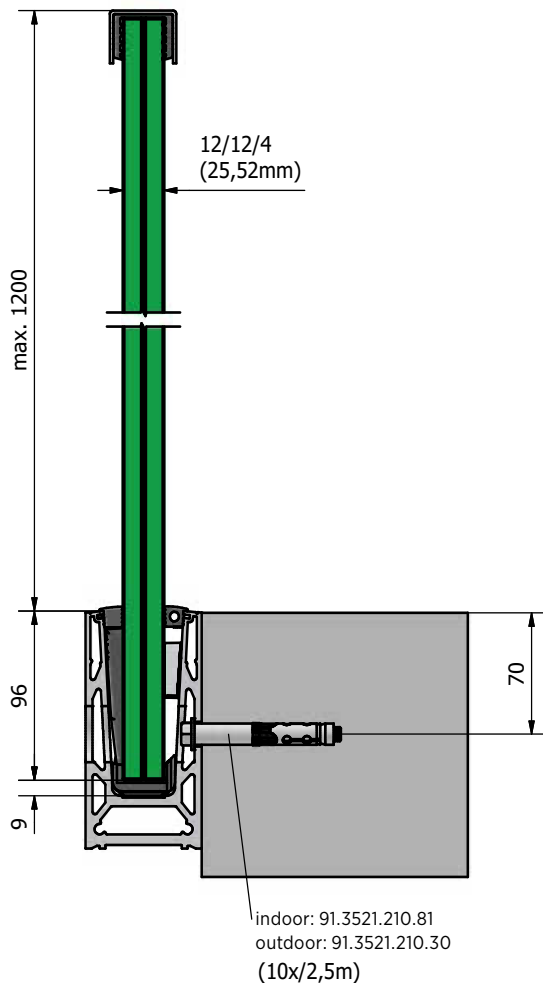



Faster and
more economic installation



Side mount

Integrated multifunctional
sophisticated chamber for
enabling larger drilling
distances

TL-6051 | 1.0 KN SIDE MOUNT

Glass profile



| Height: 135 mm
| Width: 70 mm
| Sales unit: 1 piece

Model 6051	Mill finish	Plain aluminium	RAL coloured
Length	Art. no.	Art. no.	Art. no.
5000	10.6051.005.10	10.6051.005.11	10.6051.005.13/16/18

Inside corner 90°



| Side length inside: 130 mm
| Side length outside: 200 mm
| Sales unit: 1 piece

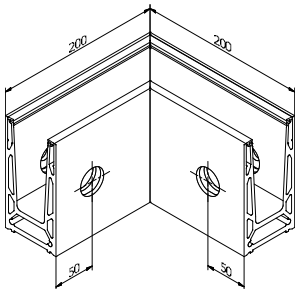

Model 6051	Mill finish	Plain aluminium	RAL coloured
	Art. no.	Art. no.	Art. no.
	10.6051.300.10	10.6051.300.11	10.6051.300.13/16/18/19

Outside corner 90°



| Side length inside: 130 mm
| Side length outside: 200 mm
| Sales unit: 1 piece

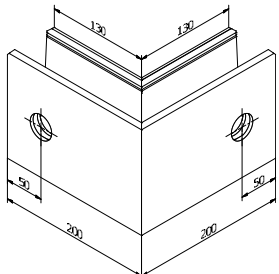

Model 6051	Mill finish	Plain aluminium	RAL coloured
	Art. no.	Art. no.	Art. no.
	10.6021.350.10	10.6021.350.11	10.6021.350.13/16/18/19

End cap, left



| For use on the left
| Sales unit: 1 piece

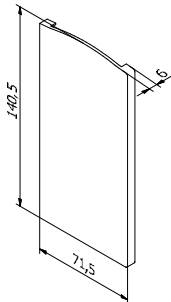

Model 6051	Mill finish	Plain aluminium	RAL coloured
Application	Art. no.	Art. no.	Art. no.
left	10.6051.400.10	10.6051.400.11	10.6051.400.13/16/18/19

TL-6051 | 1.0 KN SIDE MOUNT

End cap, left, with cover cap



| For use on the left
| Sales unit: 1 piece

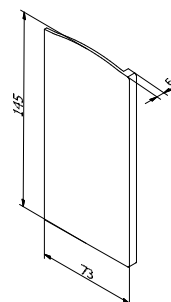

Model 6051	Mill finish	Plain aluminium	RAL coloured
Application	Art. no.	Art. no.	Art. no.
left	10.6051.410.10	10.6051.410.11	10.6051.410.13/16/18/19

End cap, right



| For use on the right
| Sales unit: 1 piece

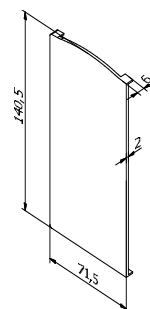

Model 6051	Mill finish	Plain aluminium	RAL coloured
Application	Art. no.	Art. no.	Art. no.
right	10.6051.450.10	10.6051.450.11	10.6051.450.13/16/18/19

End cap, right, with cover cap



| For use on the right
| Sales unit: 1 piece

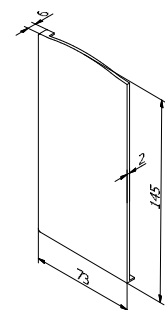

Model 6051	Mill finish	Plain aluminium	RAL coloured
Application	Art. no.	Art. no.	Art. no.
right	10.6051.460.10	10.6051.460.11	10.6051.460.13/16/18/19

End cap for staircase with cover strip, left



| For use on the left
| can be cut to size
| Sales unit: 1 piece

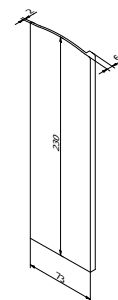

Model 6051	Mill finish	Plain aluminium	RAL coloured
Application	Art. no.	Art. no.	Art. no.
left	10.6051.411.10	10.6051.411.11	10.6051.411.13/16/18/19

TL-6051 | 1.0 KN SIDE MOUNT

End cap for staircase with cover strip, right



- | For use on the right
- | can be cut to size
- | Sales unit: 1 piece

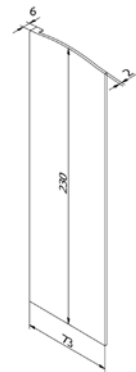

Model 6051	Mill finish	Plain aluminium	RAL coloured
Application	Art. no.	Art. no.	Art. no.
right	10.6051.461.10	10.6051.461.11	10.6051.461.13/16/18/19

Cover strip



- | For use with a cover cap, end caps must be ordered separately
- | Sales unit: 1 piece

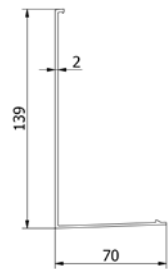

Model 6051	Mill finish	Plain aluminium	RAL coloured
Length	Art. no.	Art. no.	Art. no.
5000	10.6051.205.10	10.6051.205.11	10.6051.205.13/16/18/19

Spacer



- | Thickness: 15 mm
- | Sales unit: 10 pieces

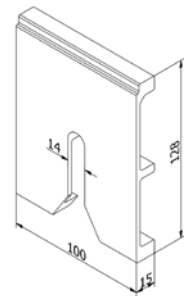

Model 6051	Mill finish	Plain aluminium	RAL coloured
	Art. no.	Art. no.	Art. no.
	10.6051.500.10	10.6051.500.11	10.6051.500.13/16/18/19

Extension pin



- | Length: 40 mm
- | Diameter: Ø 6 mm
- | Sales unit: 8 piece



Model 7001	AISI 316 (inside & outside)
	Art. no.
	90.7001.640.31

TL-6051 | 1.0 KN SIDE MOUNT

Fischer fixing anchor FH II 12/10



- | Finish interior application: zinc-plated steel (inside)
- | Finish exterior application: V4A (exterior)
- | Required number per 2500 mm: 10 pieces
- | Sales unit: 50 pieces

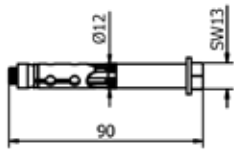

Model 3521	zinc-plated steel (interior)	AISI 316 (exterior)
	Art. no.	Art. no.
	91.3521.210.81	91.3521.210.30

Mounting set for steel



- | Finish interior application: zinc-plated steel (inside)
- | Finish exterior application: V4A (exterior)
- | Required number per 2500 mm: 10 pieces
- | M12 x 50 mm
- | Sales unit: 10 pieces

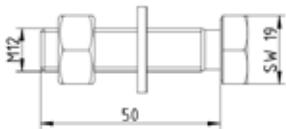

Model 6051	zinc-plated steel (interior)	AISI 316 (exterior)
	Art. no.	Art. no.
	91.6051.050.81	91.6051.050.30

FLEXFIT 2.0 kN



- | Fine adjustment of glass panes
- | For glass thicknesses between 21.52 - 31.52 mm
- | Adjustment of up to 34 mm in relation to the vertical axis
- | Attention: Make sure to use the right glass thickness!

Length		5000 mm
Glass thickness	Wedge colour	Art. no.
10/10/4 (21.52 mm)	blue	90.0505.322.00
12/12/4 (25.52 mm)	red	90.0505.326.00
15/15/4 (31.52 mm)	green	90.0505.332.00

THE ONLEVEL END CAPS RIGHT AND LEFT

Left is where your thumb is on the right.

The direction is always viewed from the fall side. Therefore, you get it right when you are not on the balcony but in front of the building.

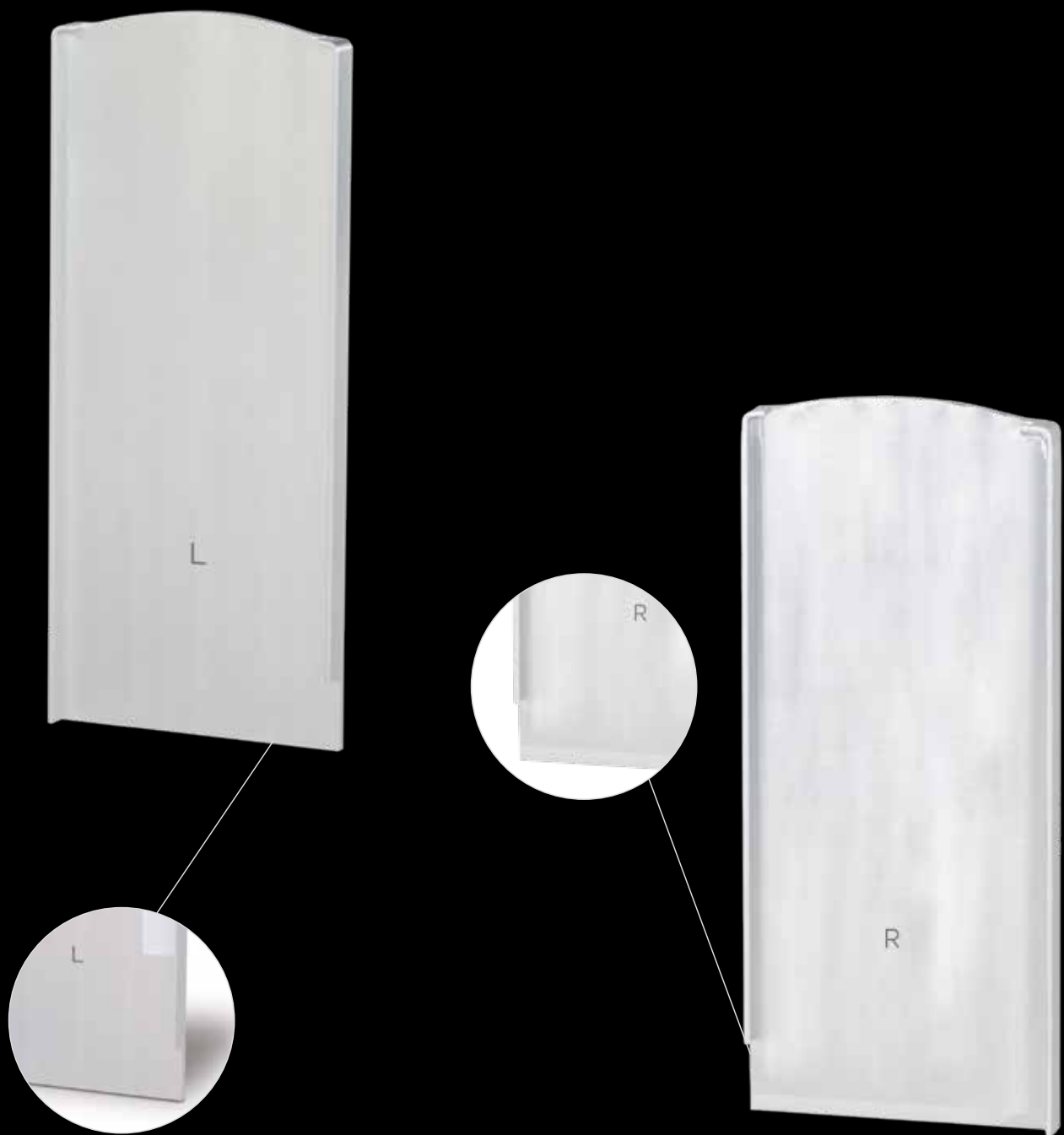

BETTER QUALITY. EXTREMELY ACCURATE. NO REWORKING.

Our products are made of steel, stainless steel V2A, V4A (exterior), and light alloy. We moreover do not just use any plastic but thermoplastic and glass fibre reinforced polymers.

They are available in all reasonable shapes and the installation is as easy as can be, which saves you time and money. And what about design? Seems you can't open your eyes wide enough to see all of this beauty. And moreover precisely tailored to your needs. Whether preassembled, cut or bent, **ONLEVEL** will prepare everything according to your wishes and preferences.

The material. Stainless steel V2A (304), V4A (exterior) (316)

Stainless steel V2A (304) is the normal industrial standard for interior applications. If you want to enjoy a magnificent sea view, our products are ideally suited for this purpose. V4A (316) is primarily used for exterior applications and contains 2% of molybdenum ensuring high corrosion resistance.

Of course, you can also use **steel with a special protective coating**. It is extremely **resilient** and even cost-effective. Our steel products are predestined both for interior and exterior applications. A nickel sulphide layer protects them against corrosion. Apart from its functional, scratch resistant surface, steel with a protective coating is also suitable for powder coating: a congenial alliance between high wear resistance and a brilliant eye-catcher. And even cleaning is very easy: simply take warm water and soap – done!

Light alloy stands out due to its weight advantage and its high resilience at the same time. It is adequate both for interior and exterior application. Its naturally occurring oxide layer protects it against corrosion. This protection has been additionally increased due to the so-called "anodising process" creating a layer thickness of 25µ, which means you are on the safe side in any wind and weather. Light alloy products can be cleaned with warm water and soap suds.

Die-cast zinc products are not only sturdy but also particularly economic. Nevertheless, these products are susceptible to corrosion and should therefore be protected by a lacquer or coating and used for interior applications only. They can easily be cleaned with warm water and soap suds.

Attention: For batch and production related reasons, anodised aluminium surfaces may show differences in the surface finish. Within the scope of technical possibilities, **ONLEVEL** tries to keep these differences as small as possible. However, they cannot be ruled out completely. **Differences in the surface finish do therefore not constitute grounds for a complaint.**



ONLEVEL

ONLEVEL Ltd. | Unit 7, Alexandria Court | Alexandria Drive
Ashton Commerce Park | Ashton-under-Lyne | Lancashire OL7 0QN | United Kingdom
T +44 0161 804 9500 | F +44 0161 804 9505 | info@onlevel-uk.com | www.onlevel.com