

# SKY**FORCE** TOP

INSTRUCTION SHEET

ON**LEVEL**



### SCREW POSITION OVERVIEW

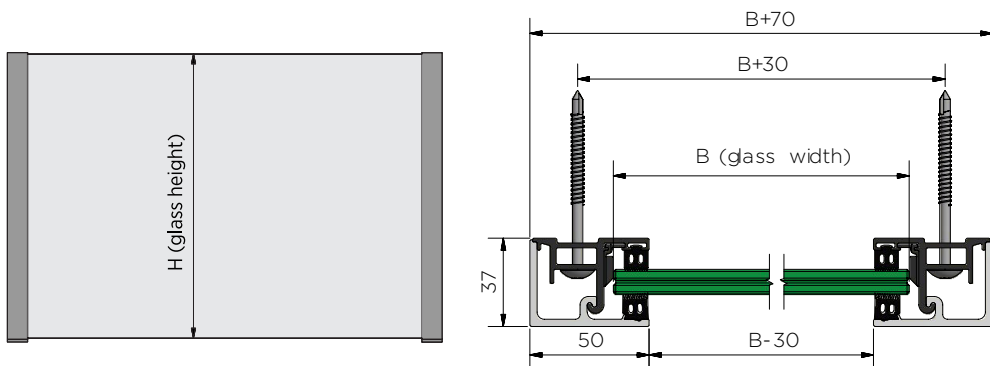

$H = 300 - 400$  mm  
(5 screws/side)

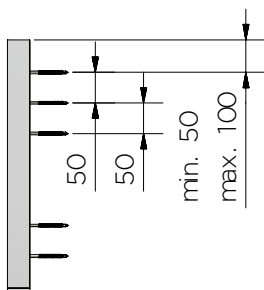

$H = 401 - 700$  mm  
(5 screws/side)

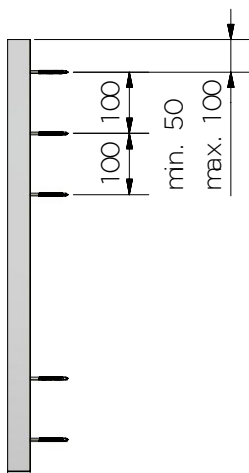

$H = 701 - 1200$  mm  
(6 screws/side)

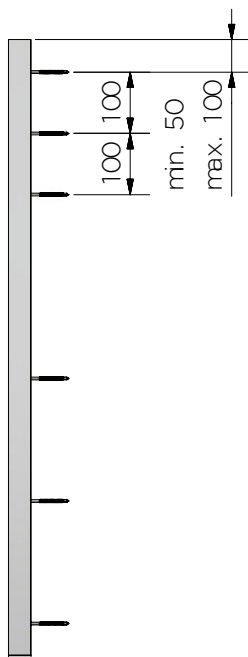

# SKYFORCE

## INSTRUCTION SHEET

# ALUMINIUM FRAME

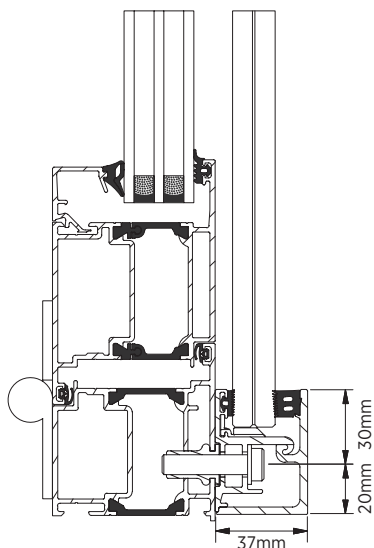
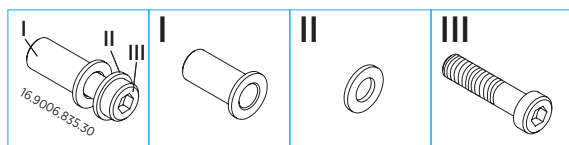
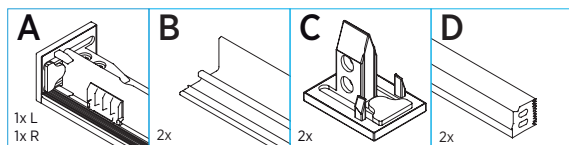

## Tools

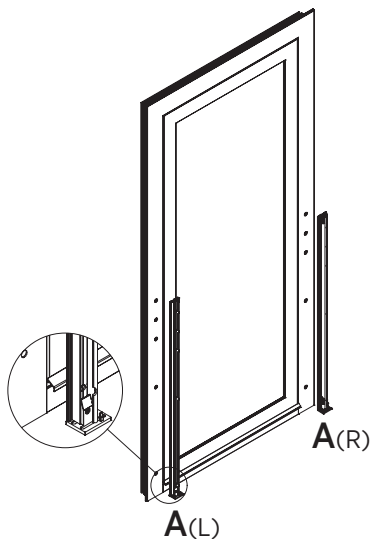
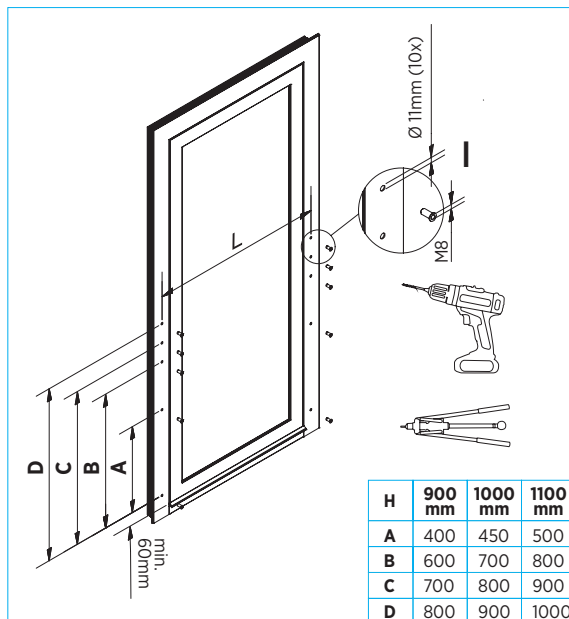
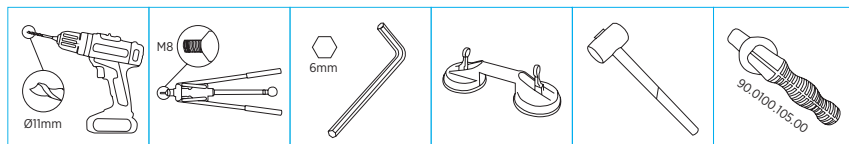

## ALUMINIUM FRAME

## ALUMINIUM FRAME

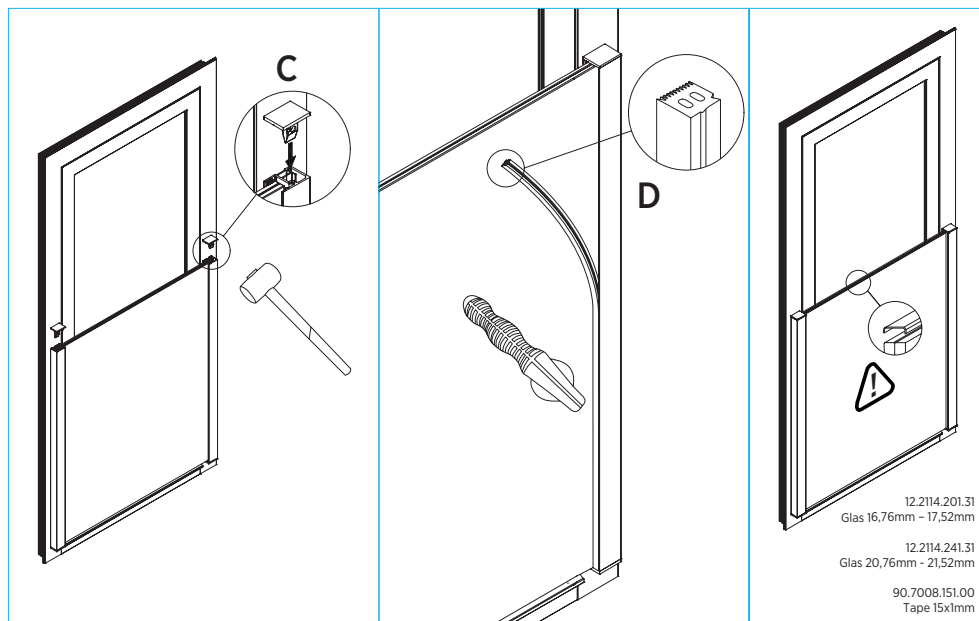

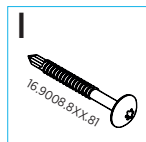
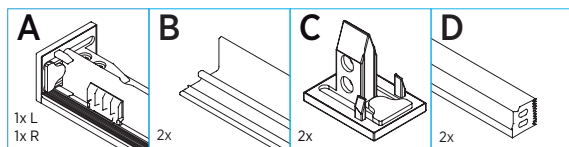

### Tools

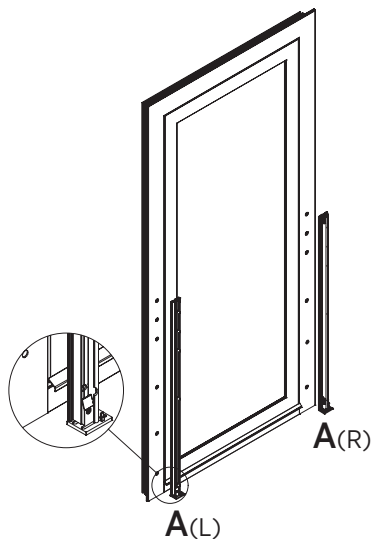
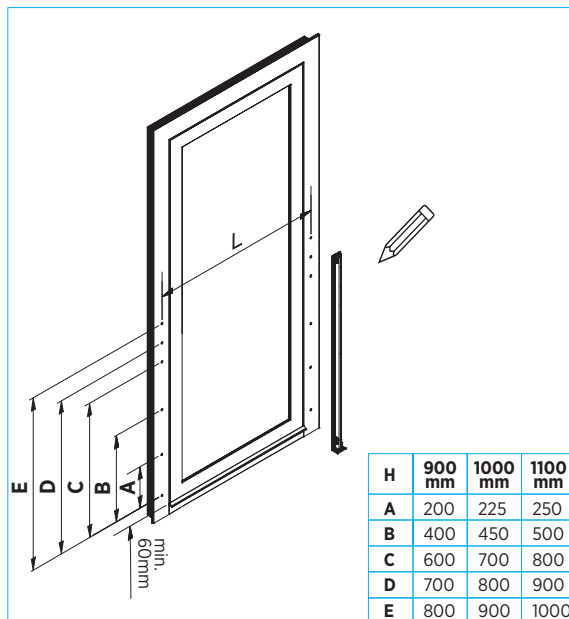
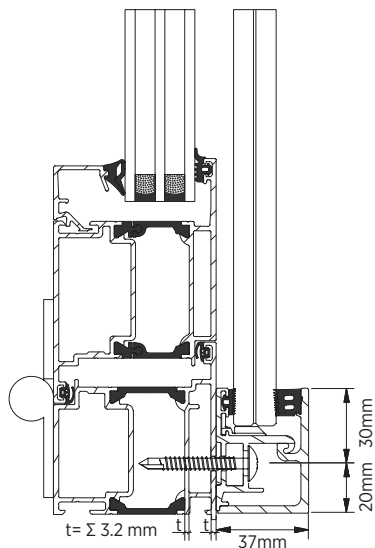
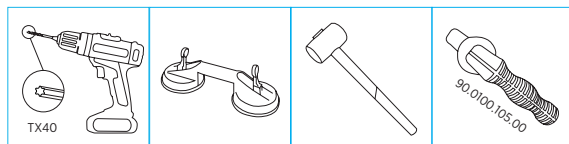

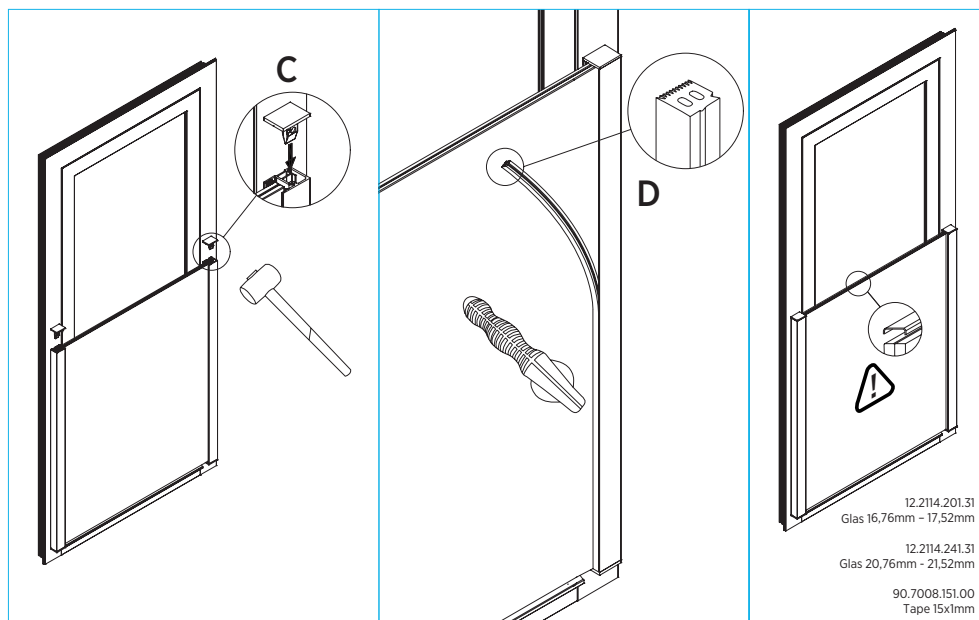
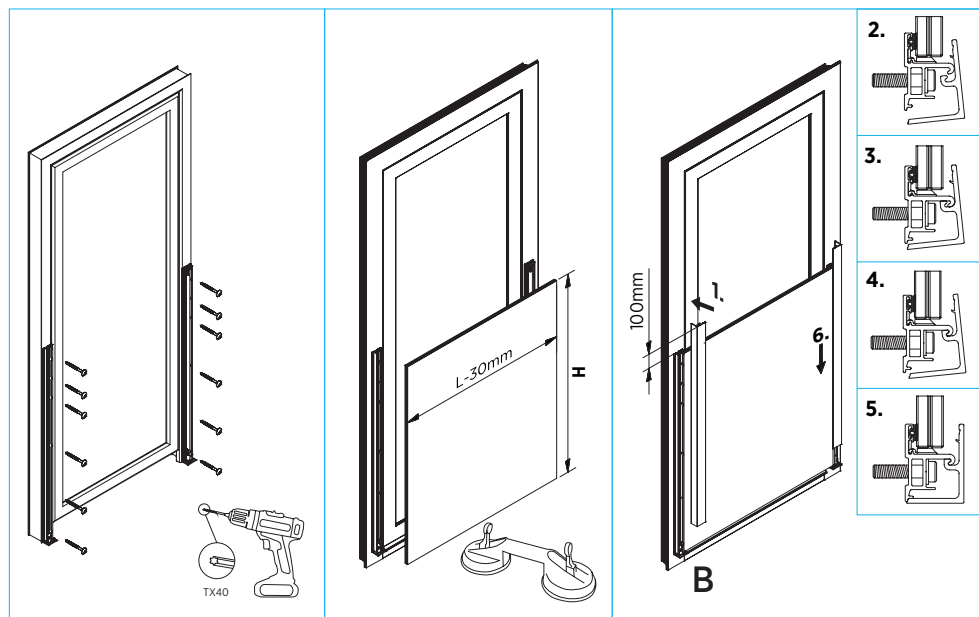

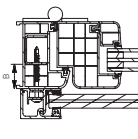
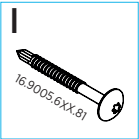
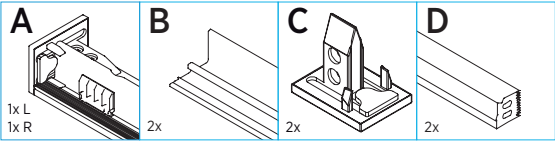

B	Art.
0-9mm	16.9005.604.81
10-19mm	16.9005.605.81
20-29mm	16.9005.606.81
30-39mm	16.9005.607.81
40-49mm	16.9005.608.81
50-59mm	16.9005.609.81
60-69mm	16.9005.610.81
80-89mm	16.9005.612.81
110-119mm	16.9005.615.81

For plastic windows, a steel inner core of min. 1,5mm necessary!

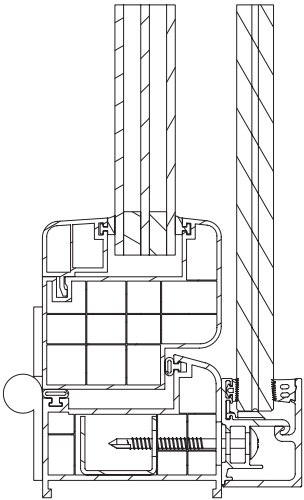

Tools

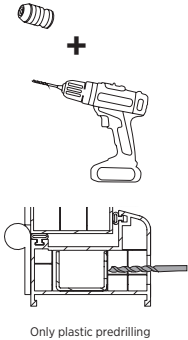
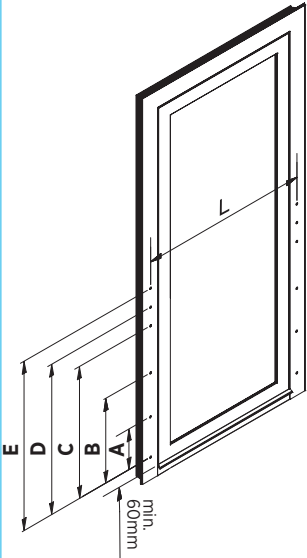
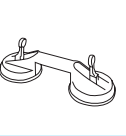
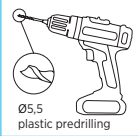

H	900 mm
A	250
B	400
C	600
D	700
E	800

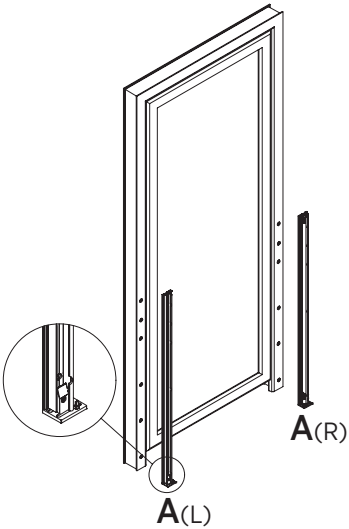



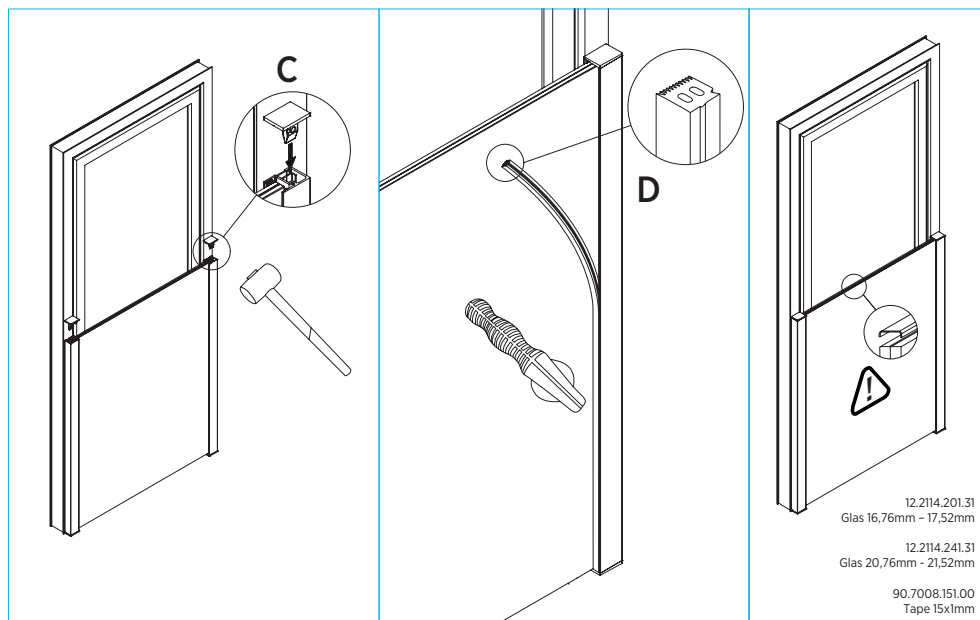
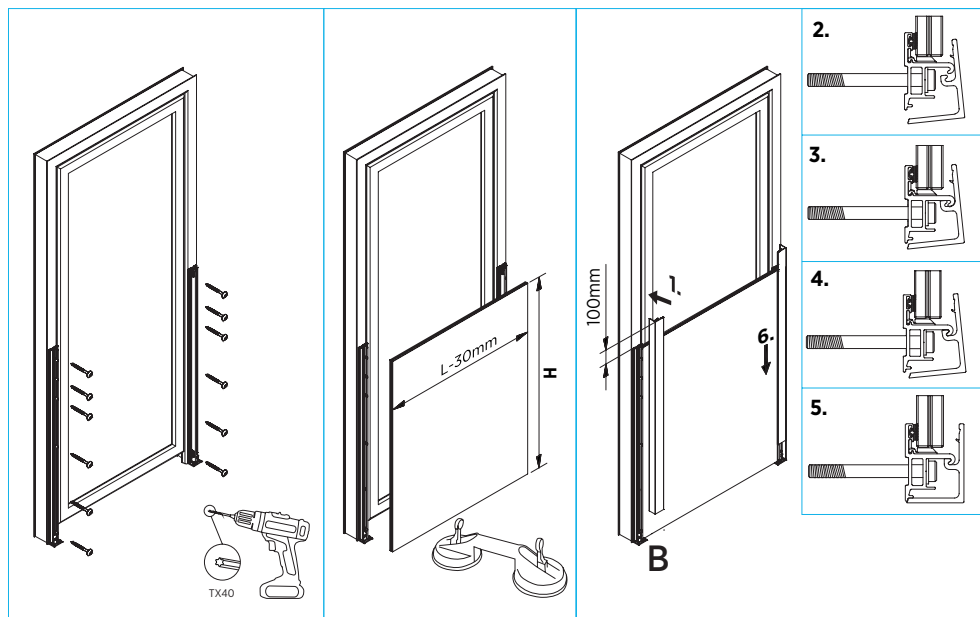

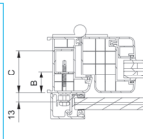
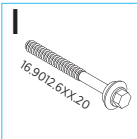
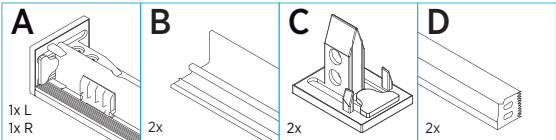

B	Art. Nr.
0 - 25 mm	16.9012.605.20
25 - 40 mm	16.9012.606.20
40 - 50 mm	16.9012.607.20
50 - 55 mm	16.9012.608.20
55 - 65 mm	16.9012.609.20
65 - 75 mm	16.9012.610.20
75 - 90 mm	16.9012.611.20

For plastic windows, a  
steel inner core  
of min. 1.5mm necessary!

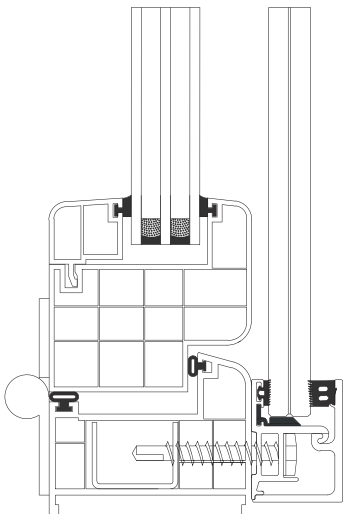

### Tools

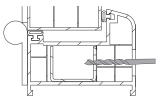
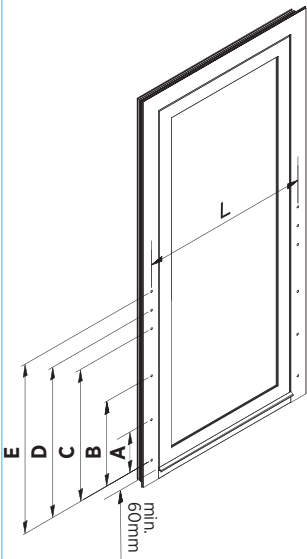
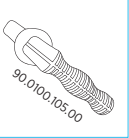
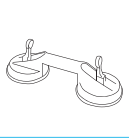

Ø5 mm (for wall thickness  
steel inner tube 1.5mm)  
Ø5,3 mm (for wall thickness  
steel inner tube 2.0 - 4.0 mm)

H	900 mm	1000 mm	1100 mm
A	200	225	250
B	400	450	500
C	600	700	800
D	700	800	900
E	800	900	1000

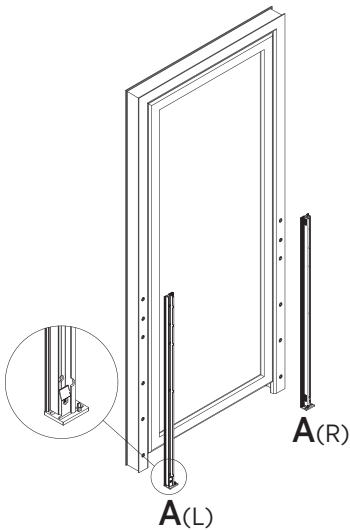

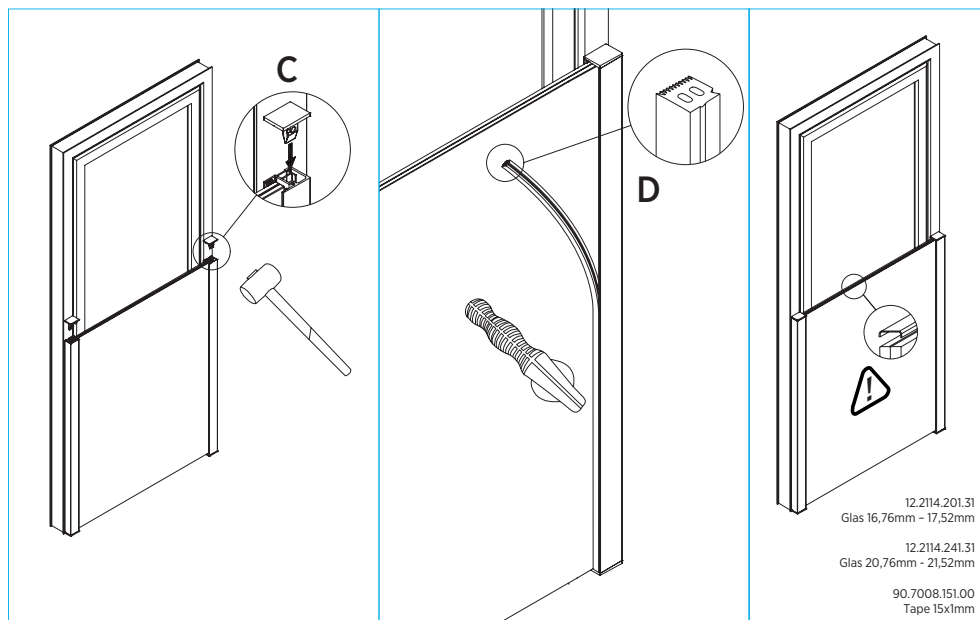
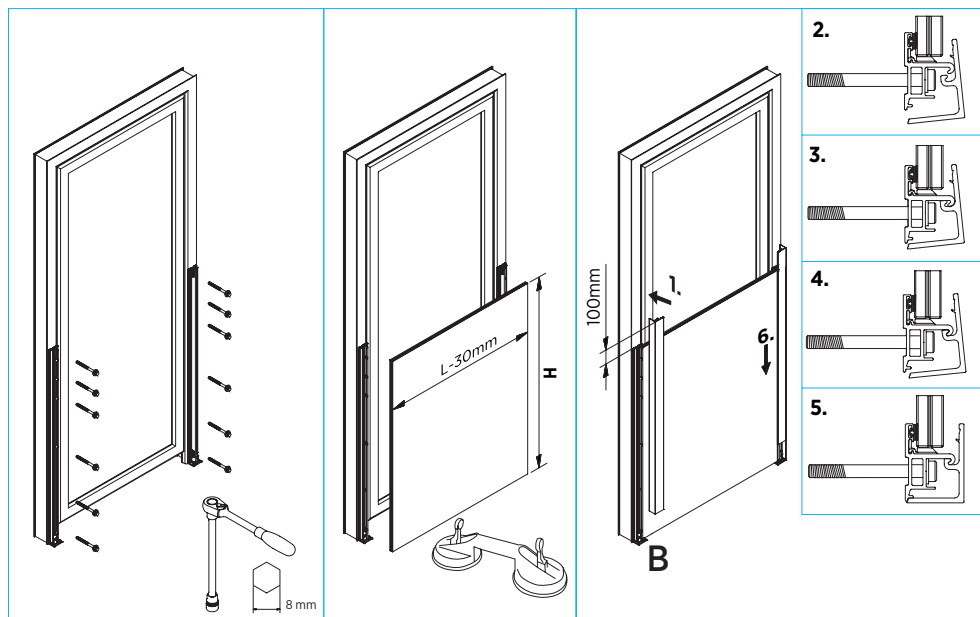

# SKYFORCE

## INSTRUCTION SHEET

# STEEL FRAME

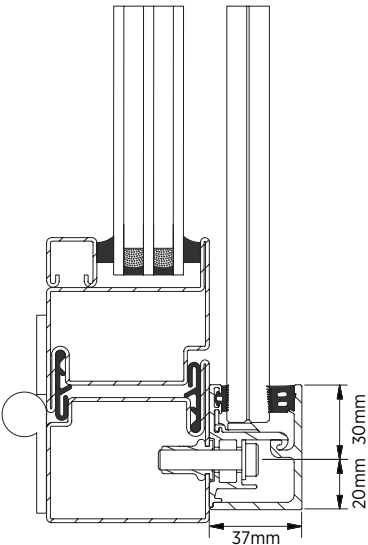
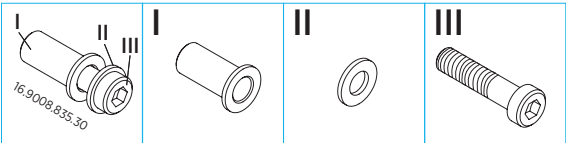
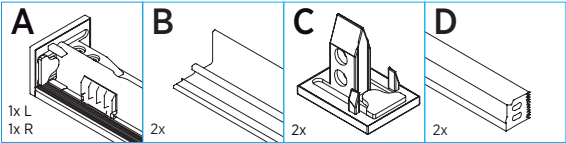

## Tools

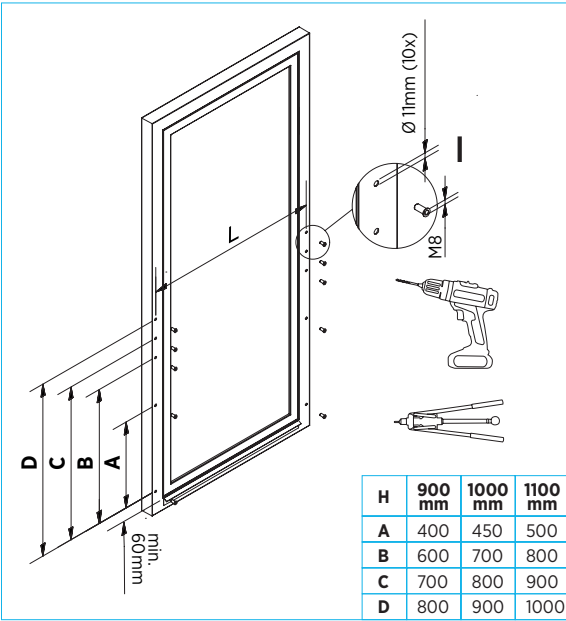
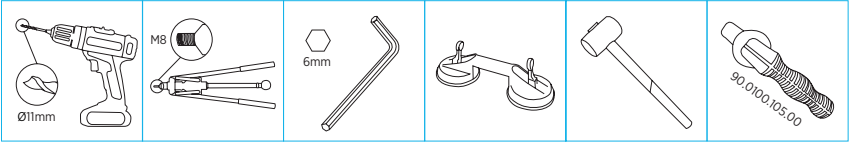

H	900 mm	1000 mm	1100 mm
A	400	450	500
B	600	700	800
C	700	800	900
D	800	900	1000

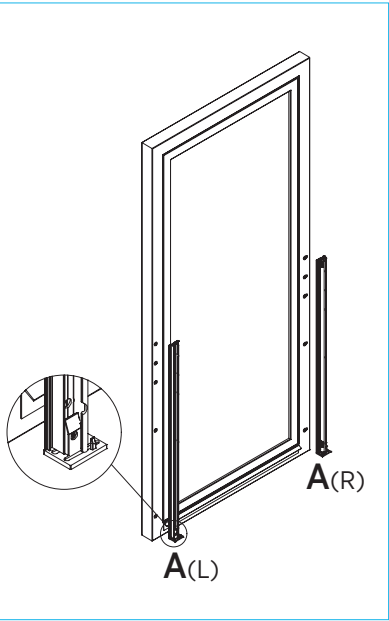

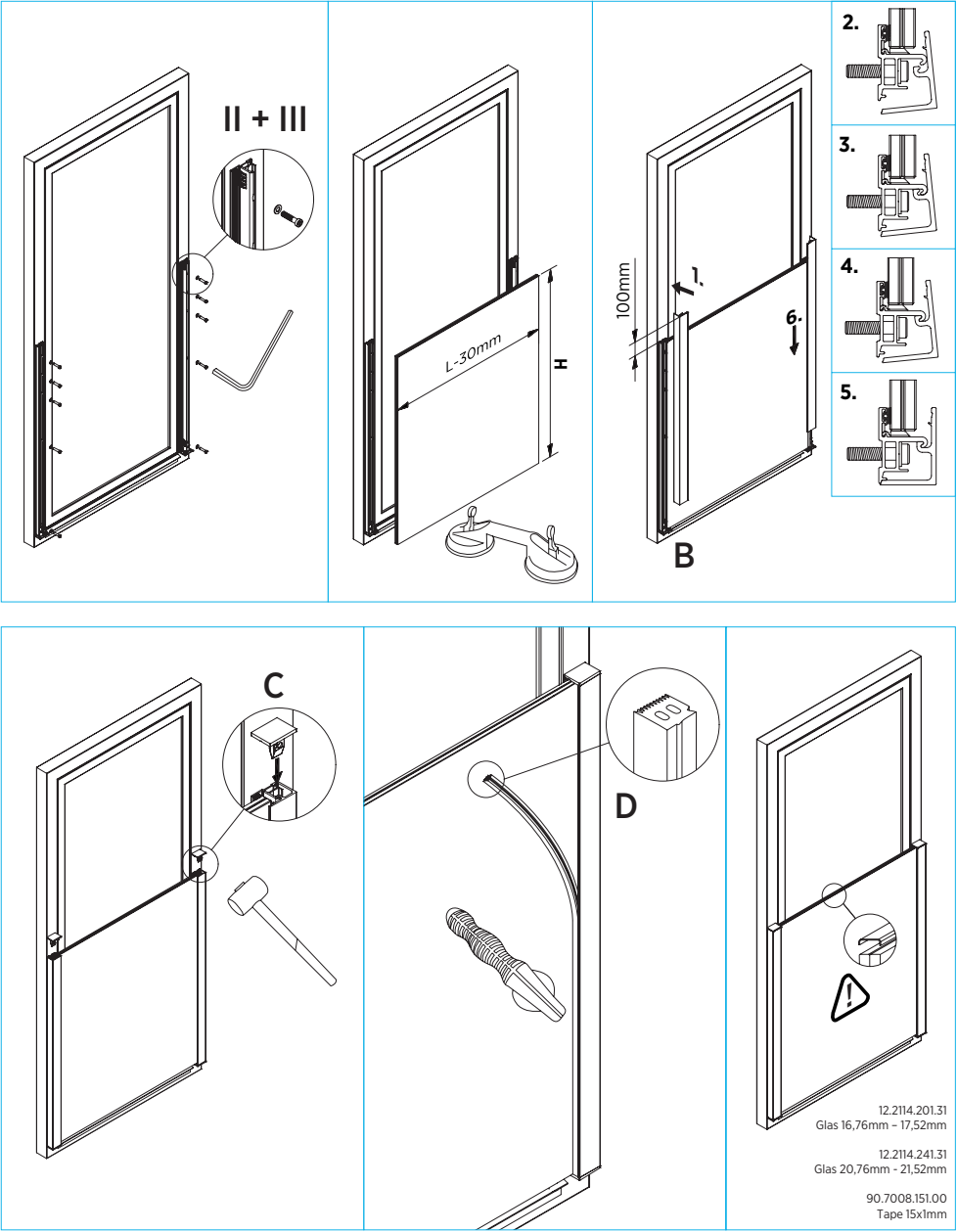

# SKYFORCE

## INSTRUCTION SHEET

# WOOD FRAME

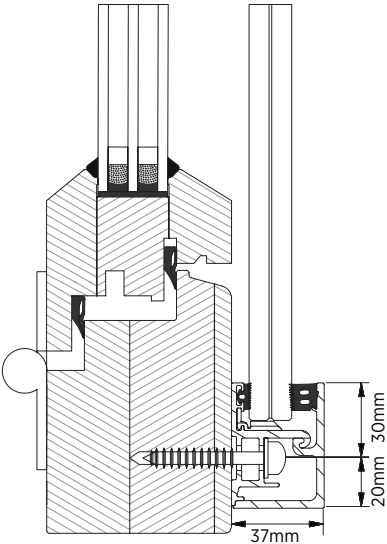
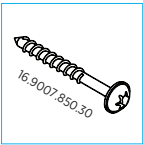
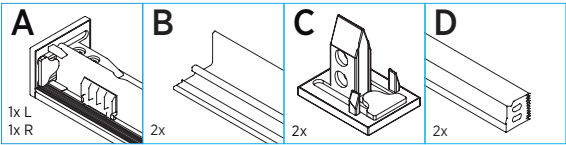

### Tools

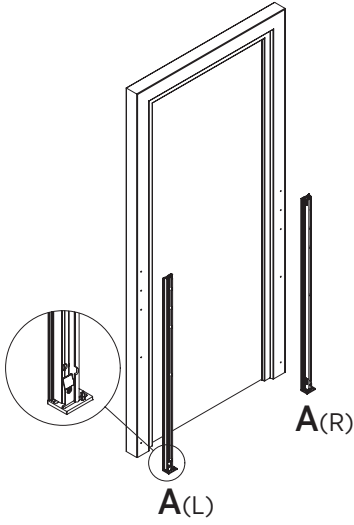
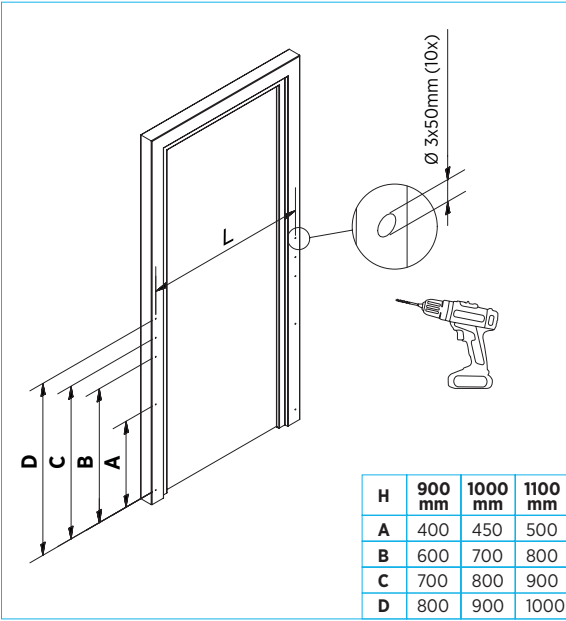
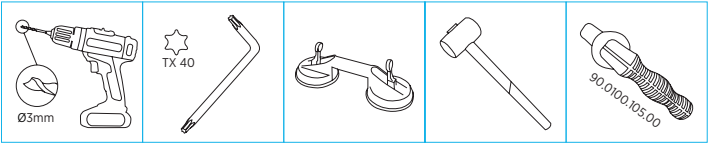

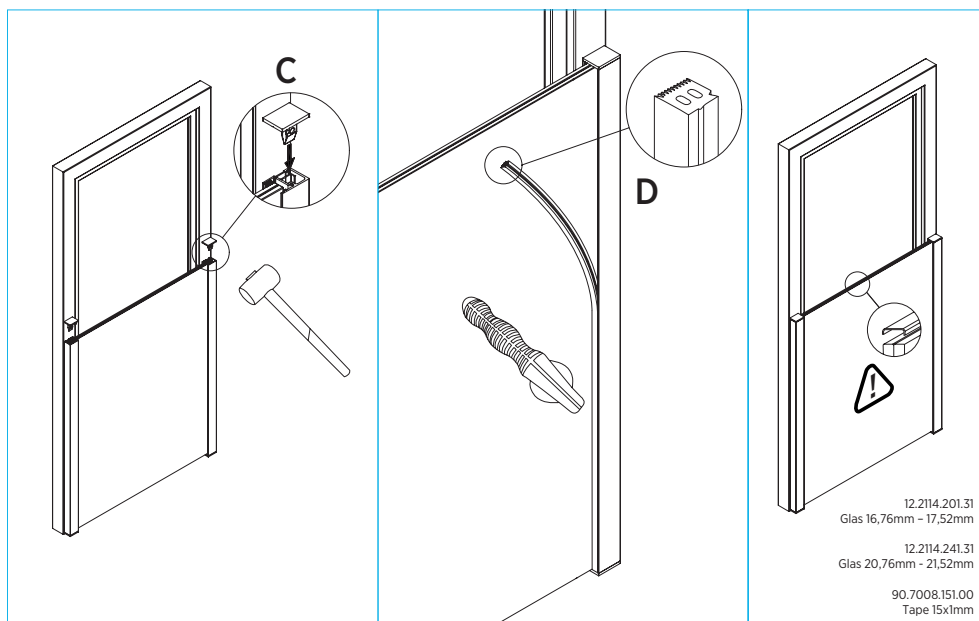
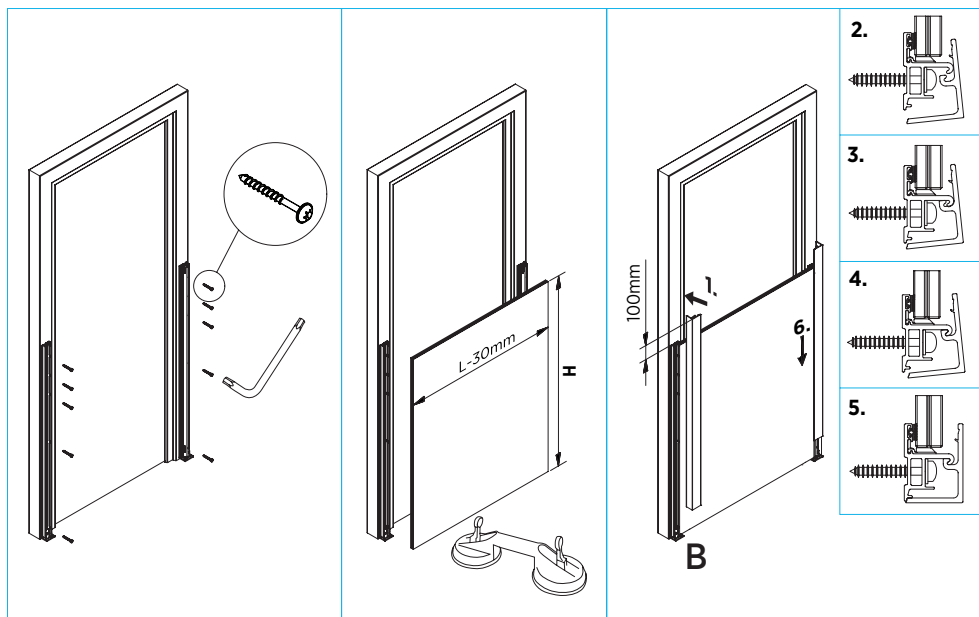

12.2114.201.31  
Glas 16,76mm - 17,52mm

12.2114.241.31  
Glas 20,76mm - 21,52mm

90.7008.151.00  
Tape 15x1mm

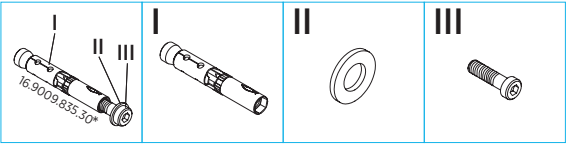
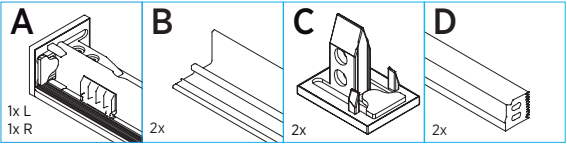

\*Anchor suitable for natural stone with dense structure

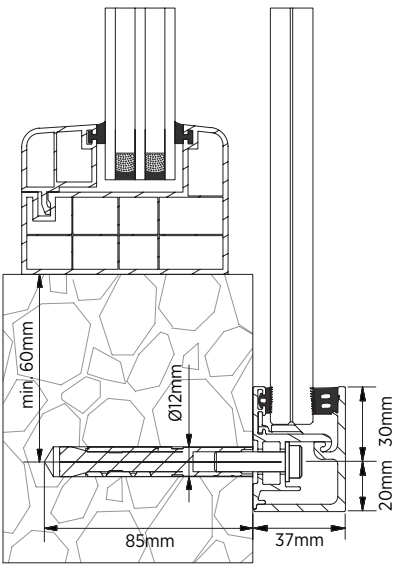

### Tools

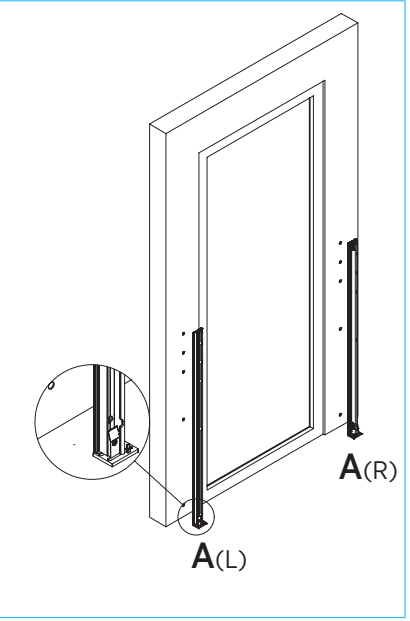
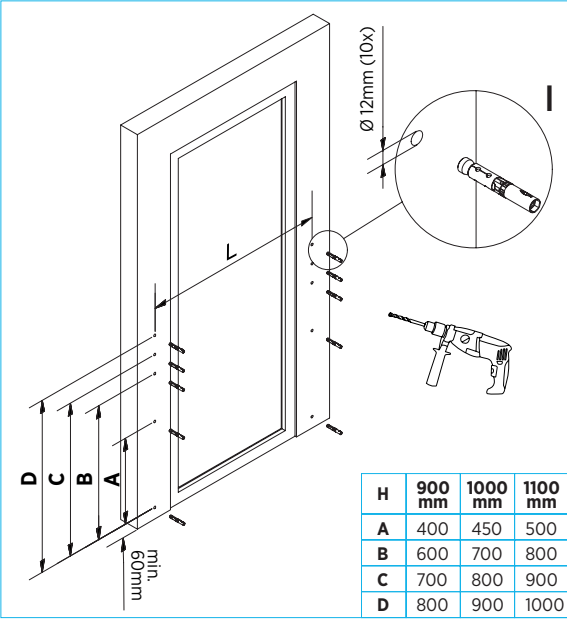
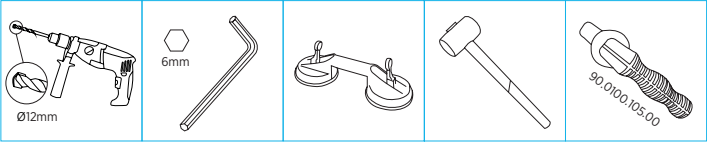



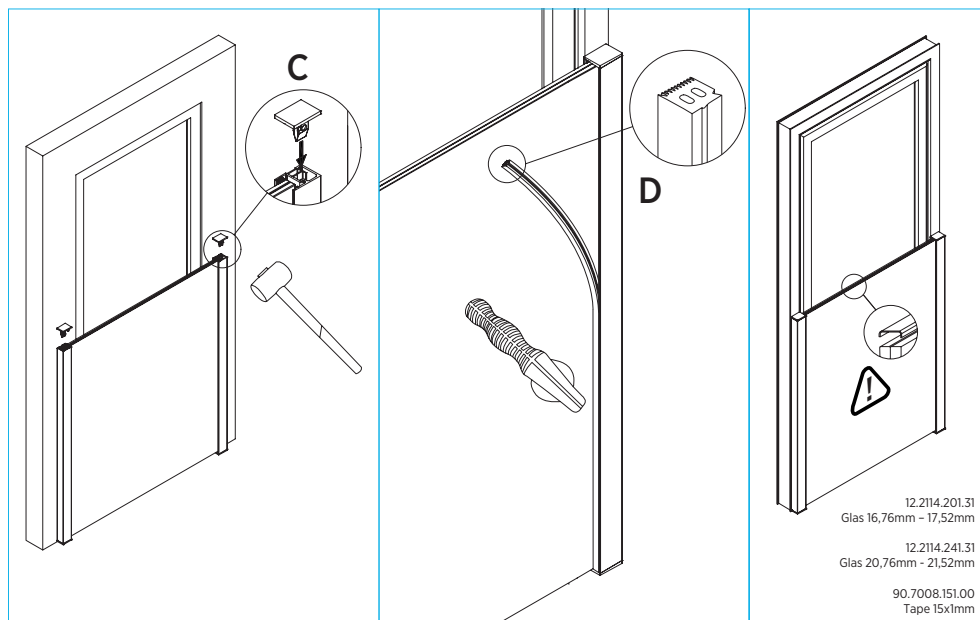
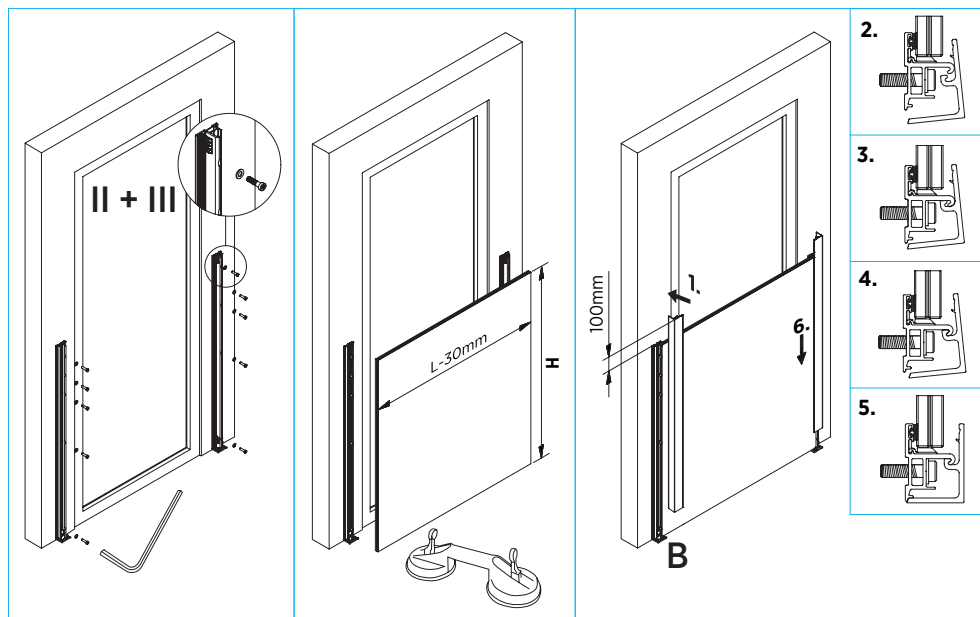

# SKYFORCE

## INSTRUCTION SHEET

# CONCRETE

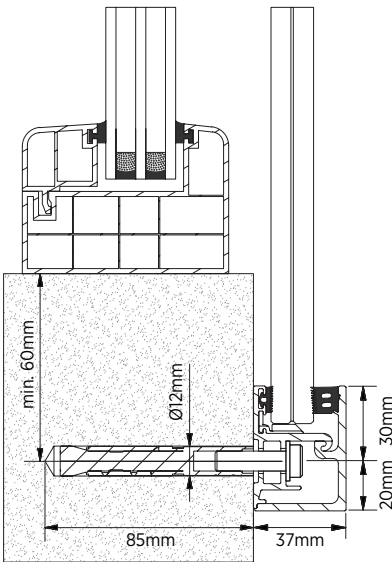
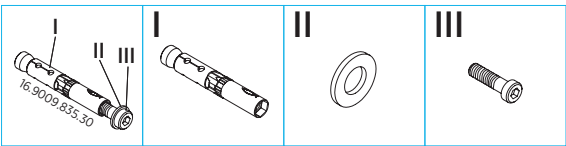
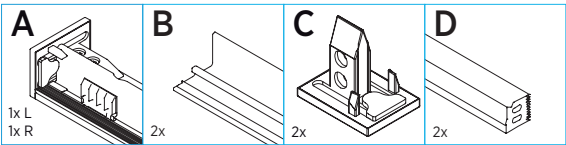

### Tools

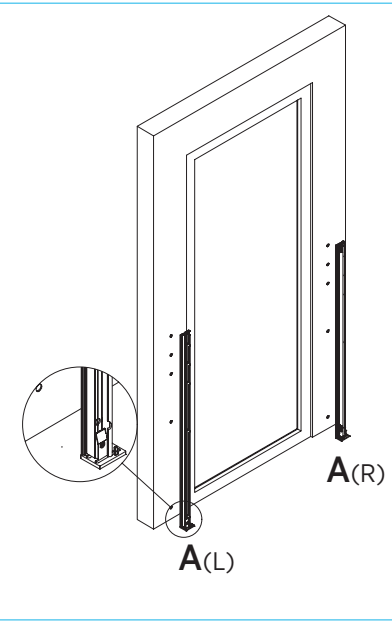
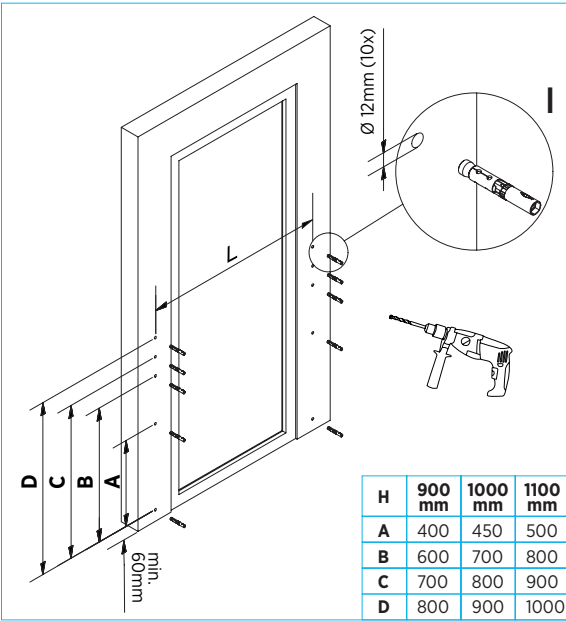
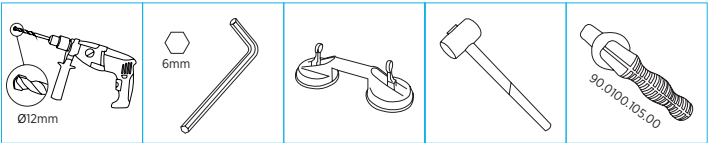

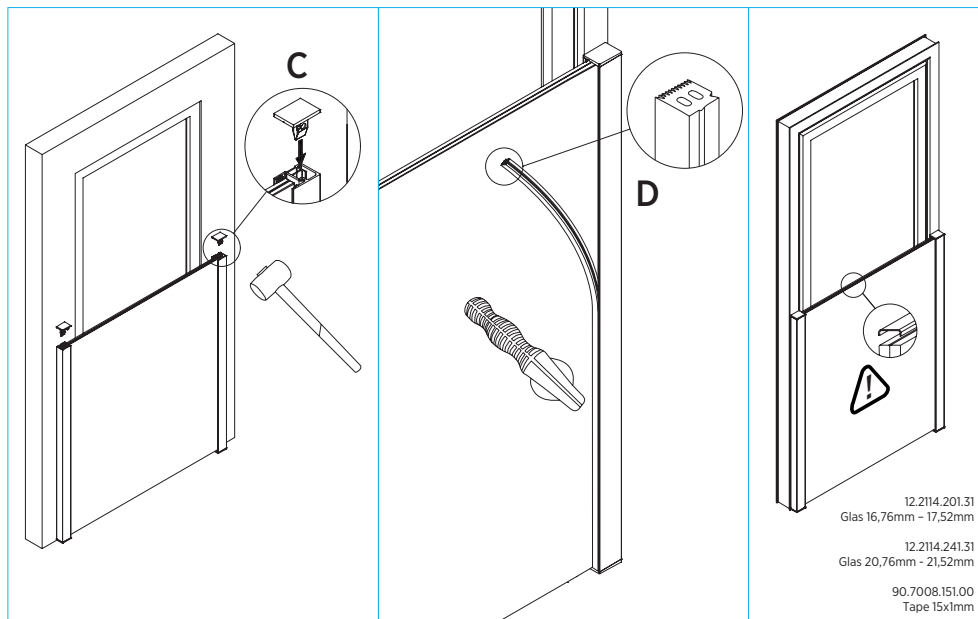
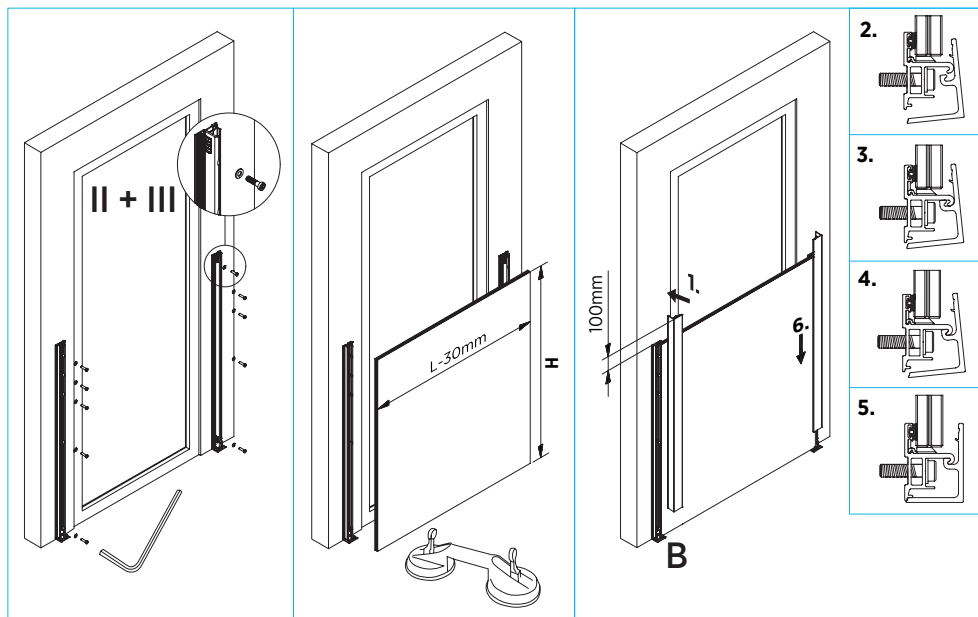



Budberger Straße 5  
46446 Emmerich am Rhein  
Deutschland

+49 (0)2822 97514-0

[info@onlevel.com](mailto:info@onlevel.com)  
[www.onlevel.com](http://www.onlevel.com)